

1979-1983 Toyota Pickup 4WD 1984-1985 Toyota Pickup 4WD 1984-1985 Toyota 4Runner 4WD Dual Steering Stabilizer Kit Installation Instructions

Required Tools List:

- SAE Sockets \ Wrenches (1/2", 9/16" & 5/8")
- Metric Sockets \ Wrenches
- Diagonal Cutting Pliers
- Ball Peen Hammer
- Measuring Tape
- Safety Glasses
- Wheel Chock
- Torque Wrench



Before beginning the installation, read these instructions thoroughly & completely. Please refer to the Parts List to insure that all parts & hardware are received prior to disassembly of the vehicle. If any parts are found to be missing, contact SKYJACKER[®] Customer Service at 318-388-0816 to obtain the needed items. If you have any questions or reservations about installing this product, contact SKYJACKER[®] Technical Assistance at 318-388-0816.

Component Box Breakdown:

Part # 7275

Item #	Description	Qty
7900WS	STEERING DAMPER, WHITE	2
B10RS	BOOT STABILIZER, RED	2
BTIE	BOOT CABLE TIE, RED	2
HSS	DECAL, HYDRO STABILIZER	2
HB-7275	HDWR BAG: 7275 / 9275	1
83092	AXLE BRACKET, DUAL	1
83100	TIE ROD BRACKET, DUAL	1

Part # 8275

Item #	Description	Qty
8900BS	STEERING DAMPER, BLACK	2
B10KS	BOOT STABILIZER, BLACK	2
BTIE-K	BOOT CABLE TIE, BLACK	2
MXSD	DECAL, BLACK MAX STABILIZER	2
HB-8275	HDWR BAG: 8275	1
83092	AXLE BRACKET, DUAL	1
83100	TIE ROD BRACKET, DUAL	1

Part # 9275

Item #	Description	Qty
9900WS	STEERING DAMPER, SILVER	2
B10KS	BOOT STABILIZER, BLACK	2
BTIE-K	BOOT CABLE TIE, BLACK	2
SSD	DECAL, SILVER STABILIZER	2
HB-7275	HDWR BAG: 7275 / 9275	1
83092	AXLE BRACKET, DUAL	1
83100	TIE ROD BRACKET, DUAL	1

Hardware Bag Breakdown:

Part # HB-7275

Item #	Description	Qty
STEM BUSH-SST	STEM BUSHINGS, RED	8
142120	WASHER PACKAGE P889/145098	4
38X418X4U	3/8 X 4-1/8 X 4 U-BOLT, SQUARE	1
38CTN	3/8-18 COURSE N/I LOCK NUT	2
38SAEW	3/8 SAE WASHER	2
516X1X134U	5/16 X 1 X 1-3/4 U-BOLT, ROUND	2
516CTN	5/16-18 COARSE N/I LOCK NUT	4
516SAEW	5/16 SAE WASHER	4
716X112FTB	7/16 X 1-1/2 FINE THREAD BOLT	1
716FTN	7/16-20 FINE N/I LOCK NUT	1
716SAEW	7/16 SAE WASHER	2

Part # HB-8275

Item #	Description	Qty
STEM SST-K	STEM BUSHING, BLACK	8
142120	WASHER PACKAGE P889/145098	4
38X418X4U	3/8 X 4-1/8 X 4 U-BOLT, SQUARE	1
38CTN	3/8-18 COURSE N/I LOCK NUT	2
38SAEW	3/8 SAE WASHER	2
516X1X134U	5/16 X 1 X 1-3/4 U-BOLT, ROUND	2
516CTN	5/16-18 COARSE N/I LOCK NUT	4
516SAEW	5/16 SAE WASHER	4
716X112FTB	7/16 X 1-1/2 FINE THREAD BOLT	1
716FTN	7/16-20 FINE N/I LOCK NUT	1
716SAEW	7/16 SAE WASHER	2

Component Box Breakdown:**Part # 7276**

Item #	Description	Qty
7900WS	STEERING DAMPER, WHITE	2
B10RS	BOOT STABILIZER, RED	2
BTIE	BOOT CABLE TIE, RED	2
HSS	DECAL, HYDRO STABILIZER	2
HB-7276	HDWR BAG: 7276 / 9276	1
83101	AXLE BRACKET, DUAL	1
83100	TIE ROD BRACKET, DUAL	1

Part # 8276

Item #	Description	Qty
8900BS	STEERING DAMPER, BLACK	2
B10KS	BOOT STABILIZER, BLACK	2
BTIE-K	BOOT CABLE TIE, BLACK	2
MXSD	DECAL, BLACK MAX STABILIZER	2
HB-8276	HDWR BAG: 8276	1
83101	AXLE BRACKET, DUAL	1
83100	TIE ROD BRACKET, DUAL	1

Part # 9276

Item #	Description	Qty
9900WS	STEERING DAMPER, SILVER	2
B10KS	BOOT STABILIZER, BLACK	2
BTIE-K	BOOT CABLE TIE, BLACK	2
SSD	DECAL, SILVER STABILIZER	2
HB-7276	HDWR BAG: 7276 / 9276	1
83101	AXLE BRACKET, DUAL	1
83100	TIE ROD BRACKET, DUAL	1

Hardware Bag Breakdown:**Part # HB-7276**

Item #	Description	Qty
STEM BUSH-SST	STEM BUSHINGS, RED	8
142120	WASHER PACKAGE P889/145098	4
38X418X4U	3/8 X 4-1/8 X 4 U-BOLT, SQUARE	1
38CTN	3/8-18 COURSE N/I LOCK NUT	2
38SAEW	3/8 SAE WASHER	2
516X1X134U	5/16 X 1 X 1-3/4 U-BOLT, ROUND	2
516CTN	5/16-18 COARSE N/I LOCK NUT	4
516SAEW	5/16 SAE WASHER	4
716X112FTB	7/16 X 1-1/2 FINE THREAD BOLT	1
716FTN	7/16-20 FINE N/I LOCK NUT	1
716SAEW	7/16 SAE WASHER	2

Part # HB-8276

Item #	Description	Qty
STEM SST-K	STEM BUSHING, BLACK	8
142120	WASHER PACKAGE P889/145098	4
38X418X4U	3/8 X 4-1/8 X 4 U-BOLT, SQUARE	1
38CTN	3/8-18 COURSE N/I LOCK NUT	2
38SAEW	3/8 SAE WASHER	2
516X1X134U	5/16 X 1 X 1-3/4 U-BOLT, ROUND	2
516CTN	5/16-18 COARSE N/I LOCK NUT	4
516SAEW	5/16 SAE WASHER	4
716X112FTB	7/16 X 1-1/2 FINE THREAD BOLT	1
716FTN	7/16-20 FINE N/I LOCK NUT	1
716SAEW	7/16 SAE WASHER	2

Pre-Installation Tips: Install Stabilizer Boot.

1. Install supplied Stabilizer Boot over Skyjacker Steering Stabilizer. Attach boot to cylinder body with supplied Boot Cable Tie. Remove excess cable tie with diagonal cutting pliers.

Installation: Note: Save all factory components & hardware for reuse, unless noted.

1. Chock rear tires\wheels. Ensure that vehicle transmission is in PARK and engage emergency brake. **Note:** Be sure steering wheel\wheels are pointing straight forward.
2. Disconnect OEM steering stabilizer from axle mount.
Disconnect OEM steering stabilizer from driver side OEM tie rod assembly stud mount.
Note: Stud is a tapered press fit & may be difficult to remove. Apply penetrating oil. Tap stud using a ball peen hammer to loosen.
3. **Note:** Skyjacker Axle Brackets Are Year Model Specific:
1979-1983 Toyota Pickup 4WD # 83092 1984-1985 Toyota Pickup & 4Runner 4WD # 83101
Place Skyjacker Axle Bracket against front of OEM axle next to OEM stabilizer mount.
Attach with supplied 3/8" x 4-1/8" x 4" U-bolt from back-to-front around OEM axle through Skyjacker bracket mounting holes. (See Photo # 1) Attach U-Bolts with supplied 3/8" SAE Washers & 3/8" Nylon Insert Lock Nut using a 9/16" socket\wrench. Secure, but **Do Not Completely Tighten.**

Photo # 1

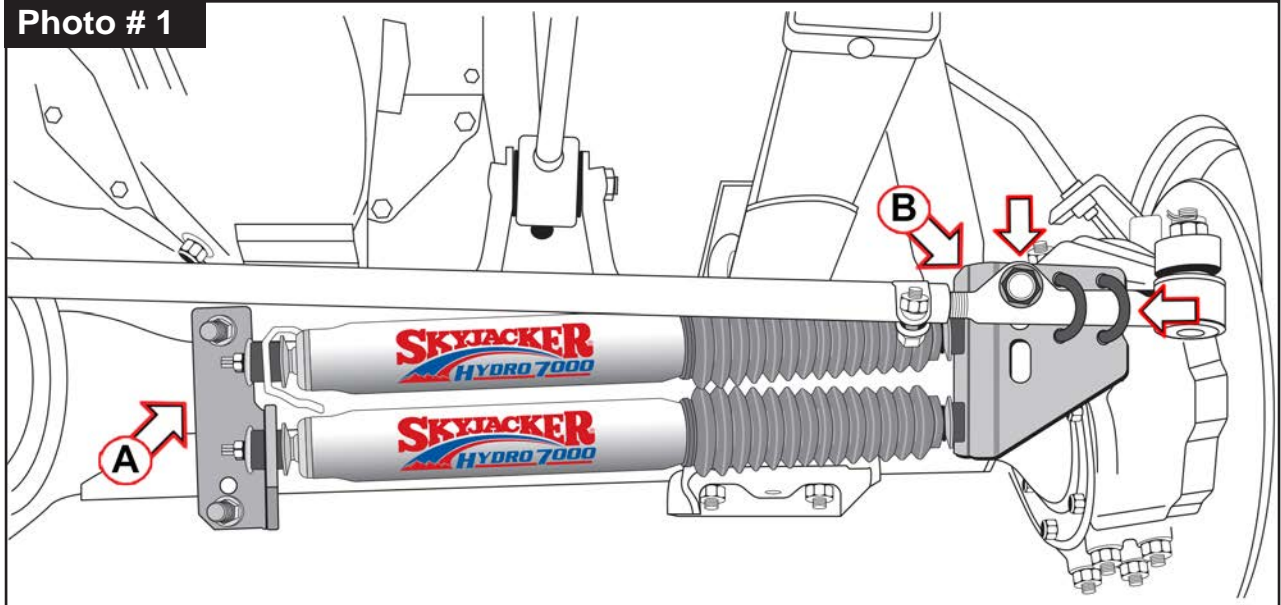

4. Place Skyjacker # 83100 Tie Rod Bracket 'B' against rear of driver side tie rod. (See Photo # 1) Install supplied 5/16" x 1" x 1-3/4" U-Bolt from front-to-rear around OEM tie rod through Skyjacker bracket mounting holes.

Attach bracket with supplied 5/16" SAE Washers & 5/16" Nylon Insert Lock Nuts using a 1/2" socket \ wrench. Secure, but **Do Not Completely Tighten**.

5. Align slotted hole of Tie Rod Bracket 'B' with OEM tie rod stud mount hole.

Insert supplied 7/16" x 1-1/2" Bolt Fine Thread Bolt with 7/16" SAE Washer from rear-to-front into OEM tie rod tab hole. Align bolt into Tie Rod Bracket 'B'. Attach with supplied 7/16" SAE Washer & 7/16" Nylon Insert Lock Nut using a 5/8" socket \ wrench. Secure, but **Do Not Completely Tighten**.

6. Attach Skyjacker Stabilizer to OEM Bracket 'A' & to Tie Rod Bracket 'B' upper tab hole with supplied Bushings, Washers & Lock Nuts using a 9/16" socket \ wrench. (See Photo # 2)

Attach Skyjacker Stabilizer to Axle Bracket 'A' & to Tie Rod Bracket 'B' lower tab hole with supplied Bushings, Washers & Lock Nuts using a 9/16" socket \ wrench.

Tighten stem lock nut until bushing starts to swell slightly.

Photo # 2

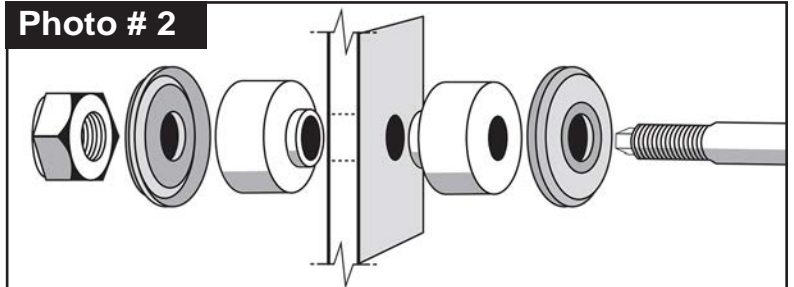

7. Extend each Skyjacker Stabilizer Shaft End out exactly half way. **4 Inches**. (See Photo # 3) Measure from end of cylinder body to shaft stem washer. Adjust brackets so full clearance is obtained.

8. Cycle steering from side to side & check for adequate clearance. Check all brackets & bolts for proper installation.

9. Torque Axle Bracket 3/8" U-Bolts 30 ft.-lbs.
Torque 7/16" Bolt 60 ft.-lbs.
Torque 5/16" U-Bolts 240 in.-lbs.

Photo # 3

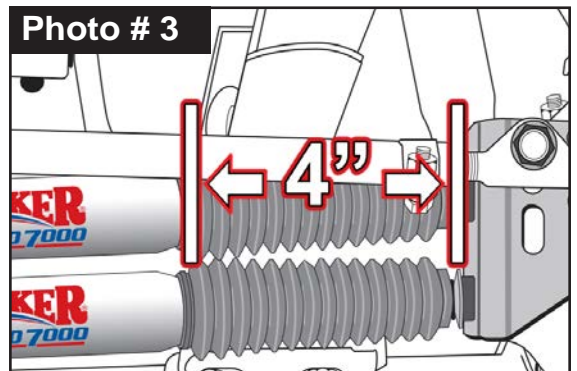

Final Notes:

- After installation is complete, double check that all nuts & bolts are tight.
- With vehicle placed on ground, cycle steering lock to lock & inspect steering for proper operation, tightness & adequate clearance.
- After first 100 miles, check all hardware for proper torque & periodically thereafter.

TORQUE SPECIFICATIONS					
INCH SYSTEM			METRIC SYSTEM		
Bolt Size	Grade 5	Grade 8	Bolt Size	Class 8.8	Class 10.9
5/16	180 in-lbs	240 in-lbs	6MM	60 in-lbs	108 in-lbs
3/8	30 ft-lbs	35 ft-lbs	8MM	216 in-lbs	23 ft-lbs
7/16	45 ft-lbs	60 ft-lbs	10MM	32 ft-lbs	45 ft-lbs
1/2	65 ft-lbs	90 ft-lbs	12MM	55 ft-lbs	75 ft-lbs
9/16	95 ft-lbs	130 ft-lbs	14MM	85 ft-lbs	120 ft-lbs
5/8	135 ft-lbs	175 ft-lbs	16MM	130 ft-lbs	165 ft-lbs
3/4	185 ft-lbs	280 ft-lbs	18MM	170 ft-lbs	240 ft-lbs
The Above Specifications Are Not to Be Used When the Bolt Is Being Installed With a Bushing.					

Seat Belts Save Lives. Please Wear Your Seat Belt.