

Required Tools List:

- SAE Sockets \ Wrenches
- Metric Sockets \ Wrenches
- Diagonal Cutting Pliers
- Pitman Arm Puller Tool
- Angle Drill • Drill
- 1/8", 1/4", 7/16 & 1/2" Drill Bits
- Punch • Center Punch
- Hammer • Cut-Off Tool
- Power Grinder • Air Chisel
- Safety Glasses • Masking or Duct Tape
- Jack Stands • Wheel Chock
- Floor Jack • Paint Marker
- Measuring Tape • Torque Wrench



Before beginning installation, read these instructions & enclosed driver's WARNING NOTICE thoroughly & completely. Also affix WARNING decal in passenger compartment in clear view of all occupants. Please refer to Parts List to insure that all parts & hardware are received prior to disassembly of vehicle. If any parts are found to be missing, contact SKYJACKER® Customer Service at 318-388-0816 to obtain needed items. If you have any questions or reservations about installing this product, contact SKYJACKER® Technical Assistance at 318-388-0816.

Please Record Important Measurement Information Below for Reference.

It Is Very Helpful on Determining an Accurate Achieved Lift Height Measurement.

Make sure you park vehicle on a level concrete or asphalt surface. Many times a vehicle is not level (side-to-side) from factory, but is usually not noticed until a lift kit has been installed which makes difference more visible. Using a measuring tape, measure front & rear (both sides) from ground up to center of fender opening above axle.

Driver Side Front: _____ / _____	Passenger Side Front: _____ / _____
BEFORE / AFTER	BEFORE / AFTER
Driver Side Rear: _____ / _____	Passenger Side Rear: _____ / _____
BEFORE / AFTER	BEFORE / AFTER

Important Notes:

- Lift Height Is Determined by Amount of Front Lift to Vehicle While Lifting Rear to a More Level Stance With Front Lift Height.
- If Larger Tires (10% More Than OEM Diameter) Are Installed, Speedometer Recalibration Will Be Necessary. Contact Your Local FORD Dealer or an Authorized Skyjacker® Dealer for Details.
- After Installation, a Qualified Alignment Facility Is Required to Align Vehicle to OEM Specifications. If vehicle cannot be brought to within +/- 1/2° of OEM Specifications, Adjustable Camber \ Caster Alignment Shims May Be Required. (Part # 1032H. Requires 1 Per Side).
- Skyjacker® Offers Sway Bar Lowering Bracket Kits. (# SBL20 for 4" lifts & # SBL40 for 6" lifts).
- Skyjacker® Offers Replacement Extended Length DOT Approved Brake Lines.

- Skyjacker® Offers Optional Radius Arm Frame Support Bar. (Part # FSB80).
- Check OEM Vehicle Frame for Any Damage or Severe Corrosion. If There Is Any Doubt as to Condition of Chassis, Have a State Approved Alignment \Frame Specialist Check Vehicle. If There Is Any Structural Damage, Do Not Install this Kit.

Component Box Breakdown:

Part # 184

Item #	Description	Qty
184S	SOFTTRIDE COIL SPRING, 4"	2

Part # 284BS

Item #	Description	Qty
LHB543-5	AXLE PIVOT BRACKET, PA\LEFT	1
LHB543-5BP	AXLE PIVOT BACKING PLATE	1
RHB543-6	AXLE PIVOT BRACKET, DR\RIGHT	1
BP125-1	BUMP STOP BRACKET, SINGLE	2
FA400	PITMAN ARM, 80-96 FORD W/PS	1
916X314X712U	9/16 X 3-1/4 X 7-1/2 U-BOLT, RD	4
HB-2846	HDWR BAG: 2846 4WD	1

Part # 284PS

Item #	Description	Qty
LHB543-5	AXLE PIVOT BRACKET, PA\LEFT	1
LHB543-5BP	AXLE PIVOT BACKING PLATE	1
RHB543-6	AXLE PIVOT BRACKET, DR\RIGHT	1
BP125-1	BUMP STOP BRACKET, SINGLE	2
FA400	PITMAN ARM, 80-96 FORD W/PS	1
916X314X912U	9/16 X 3-1/4 X 9-1/2 U-BOLT, RD	4
HB-2846	HDWR BAG: 2846 4WD	1

Hardware Box Breakdown:

Part # HB-2846

Item #	Description	Qty
12FTN	1/2-20 FINE N/I LOCK NUT	7
12SAEW	1/2 SAE WASHER	14
12X112FTB	1/2 X 1-1/2 FINE THREAD BOLT	7
516FTN	5/16 FINE N/I LOCK NUT	2
516SAEW	5/16 SAE WASHER	4
516X1FTB	5/16 X 1 FINE THREAD BOLT	2
716FTN	7/16-20 FINE N/I LOCK NUT	4
716SAEW	7/16 SAE WASHER	8
716X112FTB	7/16 X 1-1/2 FINE THREAD BOLT	4
916FTN	9/16-18 FINE N/I LOCK NUT	9
916X312FTB	9/16 X 3-1/2 FINE THREAD BOLT	1
916SAEW	9/16 SAE WASHER	2

Component Box Breakdown:

Part # 186

Item #	Description	Qty
186S	SOFTTRIDE COIL SPRING, 6"	2

Part # 286B

Item #	Description	Qty
LHB543-5	AXLE PIVOT BRACKET, PA\LEFT	1
LHB543-5BP	AXLE PIVOT BACKING PLATE	1
RHB543-6	AXLE PIVOT BRACKET, DR\RIGHT	1
BP125-1	BUMP STOP BRACKET, SINGLE	2
FA400	PITMAN ARM, 80-96 FORD W/PS	1
916X314X1312U	9/16 X 3-1/4 X 13-1/2 U-BOLT, RD	4
RB55	5.5" REAR BLOCK, TAPERED	2
HB-2846	HDWR BAG: 2846 4WD	1

Part # 286BS

Item #	Description	Qty
LHB543-5	AXLE PIVOT BRACKET, PA\LEFT	1
LHB543-5BP	AXLE PIVOT BACKING PLATE	1
RHB543-6	AXLE PIVOT BRACKET, DR\RIGHT	1
BP125-1	BUMP STOP BRACKET, SINGLE	2
FA400	PITMAN ARM, 80-96 FORD W/PS	1
916X314X912U	9/16 X 3-1/4 X 9-1/2 U-BOLT, RD	4
HB-2846	HDWR BAG: 2846 4WD	1

Part # 286P

Item #	Description	Qty
LHB543-5	AXLE PIVOT BRACKET, PA\LEFT	1
LHB543-5BP	AXLE PIVOT BACKING PLATE	1
RHB543-6	AXLE PIVOT BRACKET, DR\RIGHT	1
BP125-1	BUMP STOP BRACKET, SINGLE	2
FA400	PITMAN ARM, 80-96 FORD W/PS	1
916X314X1512U	9/16 X 3-1/4 X 15-1/2 U-BOLT, RD	4
RB45	4.5" REAR BLOCK, TAPERED	2
HB-2846	HDWR BAG: 2846 4WD	1

Part # 286PS

Item #	Description	Qty
LHB543-5	AXLE PIVOT BRACKET, PA\LEFT	1
LHB543-5BP	AXLE PIVOT BACKING PLATE	1
RHB543-6	AXLE PIVOT BRACKET, DR\RIGHT	1
BP125-1	BUMP STOP BRACKET, SINGLE	2
FA400	PITMAN ARM, 80-96 FORD W/PS	1
916X314X912U	9/16 X 3-1/4 X 9-1/2 U-BOLT, RD	4
HB-2846	HDWR BAG: 2846 4WD	1

Pre-Installation Tips: Install Shock Boots, Bushings & Sleeves.

1. Install supplied Shock Boot over Skyjacker Shock. Attach boot to cylinder body with supplied Boot Cable Tie. Remove excess cable tie with diagonal cutting pliers.
 2. On front shocks, Coat Hourglass Bushings with a water resistant grease & press into lower shock eye. Coat Sleeve & press into shock eye bushings.
 3. On rear shocks, Coat Hourglass Bushings with a water resistant grease & press into each shock eye. Coat Sleeve & press into cylinder eye bushings.
-

Front Installation: Note: Save all factory components & hardware for reuse, unless noted.

1. Chock rear tires \ wheels. Ensure that vehicle transmission is in PARK and engage emergency brake. **Note:** Be sure steering wheel \ wheels are pointing straight forward.
2. Raise front of vehicle. Place a floor jack under each outer ends of both axle halves & evenly raise vehicle. Support frame rails using jack stands at indicated lift points in OEM service manual. **Tech Note:** OEM radius arms will need to move freely during this installation. Ease vehicle down onto jack stands. Continue down with jacks until there is only a slight load on each coil spring.
3. Remove front tires \ wheels using a socket.
4. If vehicle is equipped with OEM sway bar, remove driver & passenger OEM frame mount brackets. **Note:** On some models, sway bar is mounted to OEM crossmember (instead of frame rail). Disconnect sway bar from OEM axle mount bracket. Remove sway bar assembly.
5. Remove two (2) brake caliper mounting bolts & remove brake caliper from OEM knuckle. **Note:** Hang brake caliper on frame out of way using a hook or bungee. **Do Not** hang by rubber brake line. **Tech Note:** Install an OEM lug nut to hold OEM disc brake rotor safely in place.
6. Remove cotter pin & castle nut from OEM pitman arm at OEM drag link assembly. Separate OEM drag link assembly from OEM pitman arm with pitman arm puller. **Note:** Failure to use proper tool could result in damage to steering mechanism.
7. Mark location of OEM front driveshaft & OEM front differential yoke so driveshaft can be reconnected in its OEM position. **Note:** Failure to do so may result in a driveline imbalance & subsequent vibration.

Disconnect OEM front driveshaft at u-joint. Tape u-joint caps with masking or duct tape to prevent separation. Secure driveshaft up & out of way with bungee strap or wire. **Note:** Be very careful not to pull rear end of driveshaft forward out of its splines or damage may occur to transfer case due to improper reinstallation.

8. Disconnect OEM vent hose from front differential housing.

NOTE: To Install Skyjacker Radius Arms, Refer to Separate Instructions at this Time.

9. Skyjacker Bump Stop Brackets Are Not Side Specific: # BP125-1 Driver or Passenger.

Remove OEM bump stop from driver side OEM frame rail in front of coil spring mount.

Attach OEM bump stop to Skyjacker # BP125-1 Bump Stop Bracket with OEM bolt & washer. (Illustration #1)

Attach Skyjacker \OEM bump stop assembly to OEM frame mount with supplied 5/16" x 1" Bolt with 5/16" SAE Washer. Attach above frame rail with supplied 5/16" SAE Washer & 5/16" Nylon Insert Lock Nut using a 1/2" socket \wrench.

Repeat this procedure on passenger side.

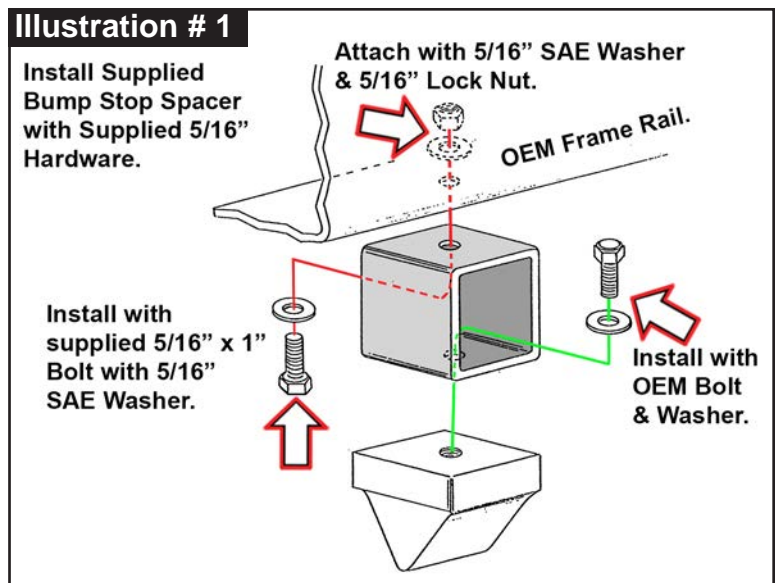

10. If equipped with OEM power steering cooler line (located on forward side of front crossmember, remove two (2) OEM bolts that holds steering cooler line at forward crossmember. Carefully move cooler line out of way.

11. Remove OEM axle pivot brackets that hold pivot end of front axle beams to front crossmember.

Tech Note: Driver side axle pivot bracket is actually located on passenger side of OEM crossmember. Passenger side axle pivot bracket is on driver side.

Note: Some OEM axle pivot brackets are bolted to frame: some are riveted. OEM brackets must be removed from crossmember by unbolting or remove rivet heads using an air chisel, power grinder, or drill. A right angle drill may be necessary to drill some rivets.

Remove OEM Rivets Steps:

- Center Punch Rivet Head.
- Drill 1/4" Pilot Hole in Center of Rivet Approximately 1/4" Deep.
- Drill Rivet Head Off Using a 7/16" Bit. Be Careful Not to Drill into Crossmember.
- Drive Rivet Out with a Hammer & Punch.

Note: Perform Steps 12-15 on Driver Side Axle Pivot Bracket.

12. Skyjacker Axle Pivot Brackets Are Side Specific: # LHB543-5 Driver & # RHB543-6 Passenger. Skyjacker Driver Axle Pivot Bracket mounts inside front of crossmember in OEM location.
13. Attach Skyjacker # LHB542-5BP Backing Plate to OEM crossmember upper OEM holes with supplied 1/2" x 1-1/2" Bolts using a 3/4" socket\wrench. (Illustration # 2)

Use Backing Plate as a guide to drill one (1) 7/16" mounting hole & one (1) 1/2" mounting hole on OEM crossmember.

Mark\scribe & center punch needed holes.

Remove Skyjacker bracket & drill 1/8" pilot holes.

CAUTION: Prior to drilling, check for any obstructions, coolant lines, wires, brake lines, fuel lines, hoses, etc that could be damaged.

Drill out pilot holes with a 7/16" or 1/2" drill bit as shown in Illustration # 2.

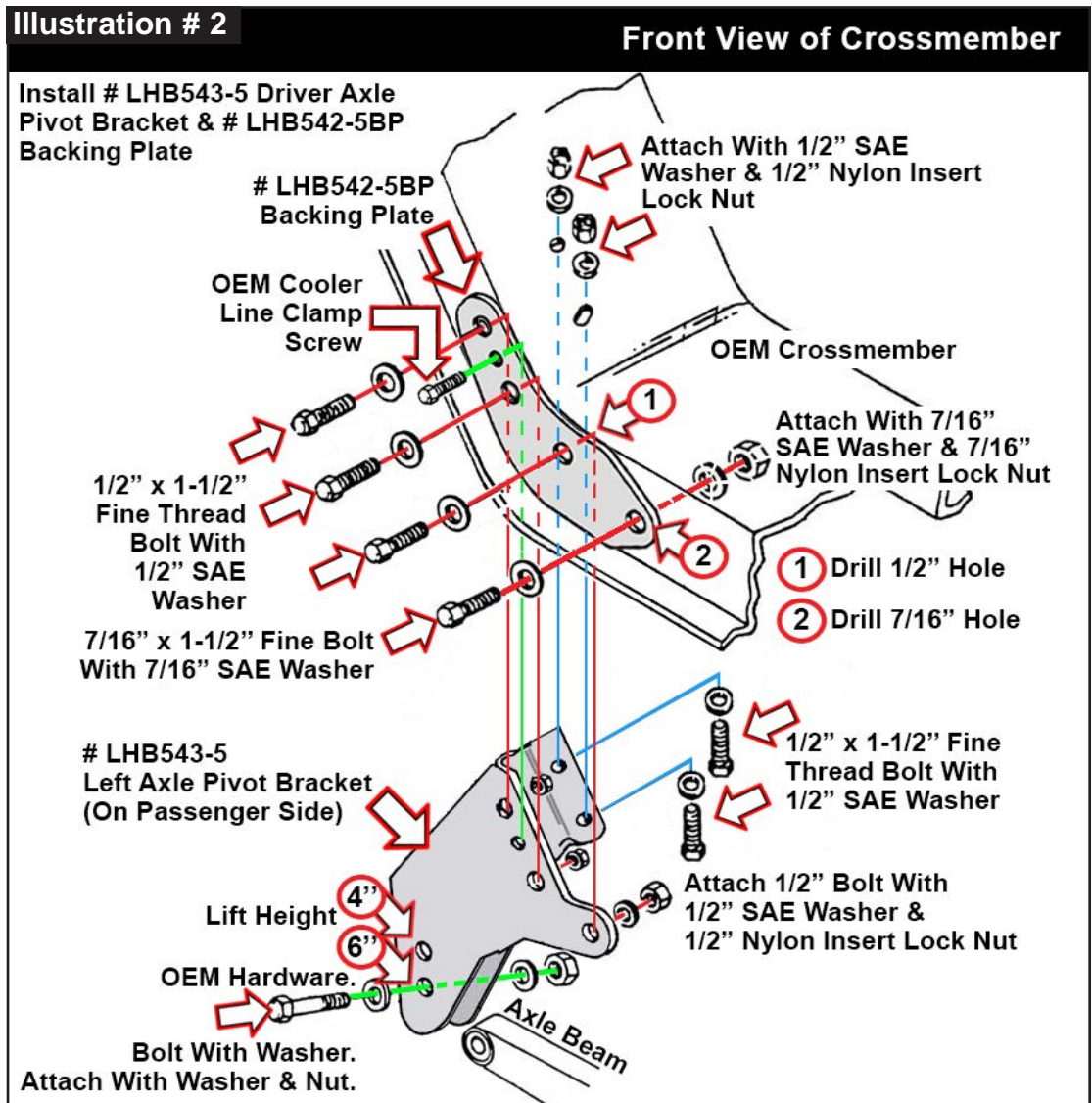

Use a wire brush, grinder brush or similar tool to remove any undercoating. Skyjacker bracket must be installed on a smooth & clean surface. Then paint all exposed metal.

14. Remove 1/2" x 1-1/2" Bolts & Backing Plate using a 3/4" socket\wrench.
Install Skyjacker # LHB543-5 Axle Pivot Bracket & # LHB542-5BP Backing Plate.
Add supplied # LT100 Thread Locking Compound to supplied bolts before attaching nuts.
Fully tighten & torque all hardware. **Torque Specifications:** 7/16" Bolts = 60 ft-lbs
1/2" Bolts = 90 ft-lbs

15. If equipped, reinstall OEM power steering cooler line with OEM screw & clamp.
Tech Note: Make Sure OEM Cooler Lines Do Not Rub or Make Contact With Any of Bolts, Bracket, or Metal Surfaces. It May Be Necessary to Bend OEM Cooler Lines or Clamps Slightly to Clear Any Obstructions.

Note: Perform Steps 16-18 on Passenger Side Axle Pivot Bracket.

16. Install # RHB543-6 Passenger Axle Pivot Bracket (actually located on driver side of OEM crossmember). (Illustration # 3) Skyjacker Bracket mounts inside rear of crossmember at OEM location.

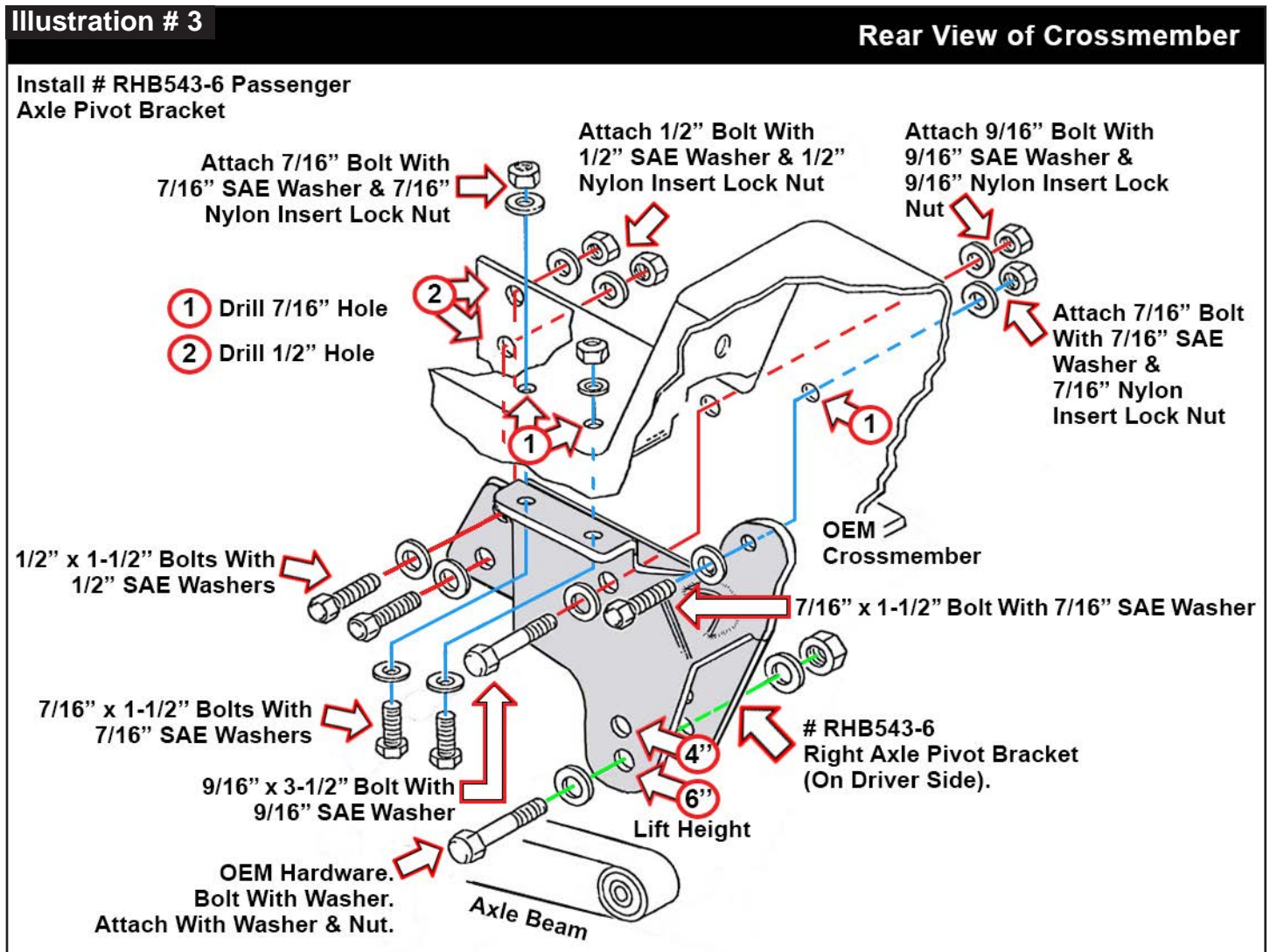

Use Skyjacker bracket as a guide for a total of five (5) mounting holes on OEM crossmember. Two (2) 1/2" mounting holes & three (3) 7/16" mounting holes.

Mark\scribe & center punch needed holes (Illustration # 3)

Remove Skyjacker bracket & drill 1/8" pilot holes. **CAUTION:** Prior to drilling, check for any obstructions, wires, brake lines, fuel lines, hoses, etc that could be damaged.

17. Drill out pilot holes with a 7/16" or a 1/2" drill bit.

Use a wire brush, grinder brush or similar tool to remove any undercoating. Skyjacker bracket must be installed on a smooth & clean surface. Then paint all exposed metal.

18. Install Skyjacker bracket with specified supplied hardware. (Illustration # 3)

Add supplied # LT100 Thread Locking Compound to supplied hardware.

Fully tighten & torque all hardware. **Torque Specifications:**

- 7/16" Bolts = 60 ft-lbs
- 1/2" Bolts = 90 ft-lbs
- 9/16" Bolts = 130 ft-lbs

Note: Perform Step 19 on One Side at a Time. Then Proceed to Step 20.

19. Using a floor jack, raise & position one of OEM axle beam into appropriate OEM axle pivot bracket. Insert OEM axle pivot bolt with washer through OEM bracket & axle beam bushing mount. Attach with OEM washer & nut using an 18mm & 21mm socket \wrench. (See Illustration # 2 & # 3) Secure, but **Do Not Completely Tighten** at this time.

Repeat this procedure on opposite side.

NOTE: Install Skyjacker Replacement Part # FA400 Pitman Arm, Install Now Per Separate Instructions. Then Proceed to Step 20.

20. Connect OEM drag link assembly to Skyjacker pitman arm. Install OEM castle nut & cotter pin to OEM drag link assembly.

NOTE: If Installing Skyjacker Replacement Stainless Steel Brake Lines, Install Now Per Separate Instructions. Then Proceed to Step 21.

21. Reinstall OEM brake caliper to OEM knuckle with OEM brake caliper mounting bolts. Torque 22-27 ft-lbs. **Note:** If OEM brake lines are reinstalled, they must be in good condition; check for chafed spots, cracks & dry rot.

NOTE: If Installing Skyjacker Replacement Sway Bar Lowering Brackets, Install Now Per Separate Instructions. Then Proceed to Step 22. (# SBL20 for 4" lifts & # SBL40 for 6" lifts).

22. Attach OEM sway bar links at OEM coil spring \sway bar bracket using OEM hardware. Secure, but **Do Not Completely Tighten**.

Note: If OEM sway bar is mounted to a OEM crossmember (instead of OEM frame rail), it is necessary to trim OEM crossmember mount slightly. (Illustration # 4)

Full scale templates are included on Page # 11 of these instructions. (Illustration # 5) Cut out templates using 'outside' edges of lines as a guide.

Align template on outer edge of each OEM crossmember sway bar mount. (Illustration # 4) Mark \scribe template onto OEM crossmember.

Illustration # 4

If OEM Sway Bar is Mounted to a OEM Crossmember (instead of OEM Frame Rail), It Is Necessary to Trim OEM Crossmember Mount Slightly. Full-Scale Templates Are Included on Page # 11 of these instructions.

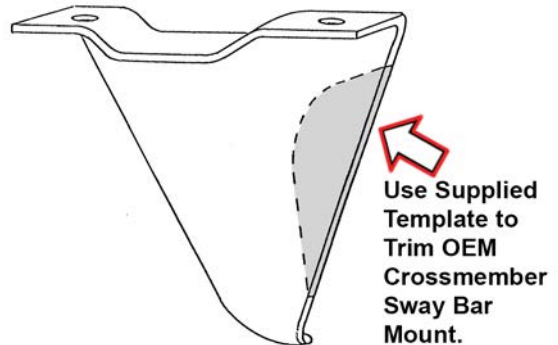

Remove OEM crossmember from OEM sway bar mount. Trim crossmember using a power grinder or cut-off tool. **Note:** File smooth any burrs or sharp edges, then paint or undercoat all exposed metal surface areas.

Reinstall crossmember. Reinstall OEM sway bar. Secure, but **Do Not Completely Tighten**.

23. Reinstall OEM axle vent hose.

24. Install front tires \wheels. Lower vehicle to ground. Torque lugs to OEM service manual specifications.

Rear Installation: **Note:** Save all factory components & hardware for reuse, unless noted.

1. Chock front tires\wheels. Raise rear of vehicle & support frame rails using jack stands at indicated lift points in OEM service manual.
2. Remove rear tires\wheels.
3. Place a floor jack underneath rear axle for support. Put a slight load on axle\jack to prevent axle from moving. Allow ample room to lower rear axle.
4. If equipped, disconnect OEM vent hose from rear differential housing.
5. Remove OEM rear shocks. Retain factory mounting hardware for re-use.
6. Remove OEM U-bolts. Discard U-bolts & hardware. Retain lower OEM U-bolt plate.
7. While checking for appropriate slack in brake lines, differential vent hose, e-brake & etc, lower rear axle to gain access to OEM rear leaf springs.

Rear Lift Option 1: Rear Block & U-Bolt Installation

6. While checking for appropriate slack in brake lines, differential vent hose, e-brake & etc. Lower axle away from leaf springs to allow clearance for Skyjacker block.

7. **1980-1996 Ford F150 4WD With 6" Lift:** Clean spring pads of all debris.
Position Skyjacker # RB45 Tapered 4.5" Rear Lift Block On Top of OEM block & axle pad.
Note: Place taller end of lift block toward rear of vehicle.

Raise axle to mate leaf springs to lift OEM block. **Note:** Be sure that leaf spring center bolt head seats properly into OEM block & that OEM block pin seats properly into top of axle pad.

8. **1980-1996 Ford Bronco 4WD With 6" Lift:** Clean spring pads of all debris.
Position Skyjacker # RB55 Tapered 5.5" Rear Lift Block On Top of OEM block & axle pad.
Note: Place taller end of lift block toward rear of vehicle.

Raise axle to mate leaf springs to lift OEM block. **Note:** Be sure that leaf spring center bolt head seats properly into OEM block & that OEM block pin seats properly into top of axle pad.

Rear Lift Option 2: Replacement Softride® Leaf Spring Installation

9. While checking for appropriate slack in ABS lines, electrical lines, brake lines, rear e-brake cables, & etc. Lower axle away from leaf springs to allow clearance for Skyjacker rear springs.
10. Remove OEM rear leaf spring. (Note direction of OEM hardware.)
Loosen front spring eye bolt. Loosen rear spring eye bolt. Loosen rear shackle eye bolt.
Disconnect spring eye bolts & remove leaf spring with rear shackle attached.
Attach 'short' end of Skyjacker leaf spring to forward frame mount with OEM hardware.
Attach 'long' end of Skyjacker leaf spring to rear shackle mount with OEM hardware.
Note: On Skyjacker springs with a degree shim, place taller end of shim toward rear of vehicle.
Secure OEM hardware, but **Do Not Completely Tighten** leaf spring hardware at this time. To set spring bushings properly for ride height, these will be tightened once vehicle is on ground with full vehicle weight on tires\wheels.

11. **1980-1996 Ford F150 4WD 4" System With # FR54S Rear Springs:**

Remove OEM blocks & install springs on top of axle.

1980-1996 Ford F150 4WD 6" System With # FR54S Rear Springs: Install springs on top of OEM blocks. **Tech Note:** Some models may sit high in rear, as it did from factory. If so, OEM rear block may be removed to lower rear of vehicle, if desired.

1980-1996 Ford F150 4WD 6" System With # FR56S Rear Springs: Remove OEM blocks & install springs on top of axle.

Raise axle to mate leaf springs to OEM axle pad and/or OEM block. **Note:** Be sure that leaf spring center bolt head seats properly into OEM block & that OEM block pin seats properly into top of axle pad.

Install Skyjacker supplied 9/16" U-bolts over axle up into OEM U-bolt plate. Install supplied 9/16" Nylon Insert Nuts using a 13/16" socket/wrench. Tighten U-bolts evenly using an 'X' crisscross tightening sequence. Torque to 95 ft-lbs. **Proceed to Step 14.**

12. **1980-1996 Ford Bronco 4WD 4" System With # FR52S Rear Springs:** Install springs on top of OEM blocks. **Tech Note:** Some models may sit high in rear, as it did from factory. If so, OEM rear block may be removed to lower rear of vehicle, if desired.

1980-1996 Ford Bronco 4WD 6" System With # FR54S Rear Springs: Install springs on top of OEM blocks. **Tech Note:** Some models may sit high in rear, as it did from factory. If so, OEM rear block may be removed to lower rear of vehicle, if desired.

Raise axle to mate leaf springs to OEM block. **Note:** Be sure that leaf spring center bolt head seats properly into OEM block & that OEM block pin seats properly into top of axle pad.

Install Skyjacker supplied 9/16" U-bolts over axle up into OEM U-bolt plate. Install supplied 9/16" Nylon Insert Nuts using a 13/16" socket/wrench. Tighten U-bolts evenly using an 'X' crisscross tightening sequence. Torque to 95 ft-lbs. **Proceed to Step 14.**

13. Install Skyjacker rear shock with OEM hardware at upper shock tower mount. Connect Skyjacker shock at lower axle mount with OEM hardware. Secure, but **Do Not Completely Tighten** at this time. To set bushings properly for ride height, these will be tightened once vehicle is on ground with full vehicle weight on tires/wheels.
14. If equipped, reconnect OEM vent hose to rear differential housing.
15. Install rear tires/wheels. Lower vehicle to ground. Torque lugs to OEM service manual specifications.

Final Clearance Check & Torque Steps:

Note: Drag Link Must Be Adjusted to Center Steering Wheel Before Vehicle Is Driven. Failure to Do So Will Cause Odd Handling Characteristics, & Poor Performance.

1. Start vehicle. Make sure there are no dash lights pertaining to suspension.
2. Jounce vehicle a couple of times. This will help suspension settle to new ride height. Cycle steering left-to-right lock-to-lock. Check all components for proper operation & clearances. Check for any binding or interference.

There should be a Minimum of 1" of Clearance Between Tires & Radius Arms at Full Lock.

Note: If Less than 1", check to make sure you have proper tire/wheel size & offset. If necessary, OEM steering stop bolts may be adjusted out to a Maximum of 1-1/4".

3. Front Tighten & Torque Sequence.

Front shock absorber upper mount using a 14mm socket\wrench. Torque 15-25 ft-lbs.

Front shock absorber lower mount using a 3/4" socket\wrench. Torque 65 ft-lbs.

Tighten sway bar links at OEM coil spring\sway bar bracket. Torque 16-21 ft-lbs.

NOTE: Remove Skyjacker Radius Arm supplied 3/4" End Nut at relocated OEM frame bracket.

Apply supplied Thread Locking Compound to Skyjacker Radius Arm nut mount.

Reinstall supplied 3/4" End Nut using a 1-1/8" socket\wrench. Torque 100 ft-lbs.

4. Rear Tighten & Torque Sequence.

Tighten Shock Bushings until bushing starts to swell slightly.

Tighten Leaf Springs in this sequence: Front spring eye bolt. Rear spring eye bolt. Rear shackle eye bolt.

Final Notes:

- After installation is complete, double check that all nuts & bolts are tight. Refer to following chart for proper torque specifications. (**Note:** Do not re-tighten nuts & bolts where thread lock compound was used.)
- With vehicle placed on ground, cycle steering lock to lock & inspect steering, suspension, brake lines, front & rear drivelines, fuel lines & wiring harnesses for proper operation, tightness & adequate clearance.
- Have headlights readjusted to proper settings.
- Have a qualified alignment center align vehicle to OEM specifications.
- After first 100 miles, check all hardware for proper torque & periodically thereafter.

TORQUE SPECIFICATIONS					
INCH SYSTEM			METRIC SYSTEM		
Bolt Size	Grade 5	Grade 8	Bolt Size	Class 8.8	Class 10.9
5/16	180 in-lbs	240 in-lbs	6MM	60 in-lbs	108 in-lbs
3/8	30 ft-lbs	35 ft-lbs	8MM	216 in-lbs	23 ft-lbs
7/16	45 ft-lbs	60 ft-lbs	10MM	32 ft-lbs	45 ft-lbs
1/2	65 ft-lbs	90 ft-lbs	12MM	55 ft-lbs	75 ft-lbs
9/16	95 ft-lbs	130 ft-lbs	14MM	85 ft-lbs	120 ft-lbs
5/8	135 ft-lbs	175 ft-lbs	16MM	130 ft-lbs	165 ft-lbs
3/4	185 ft-lbs	280 ft-lbs	18MM	170 ft-lbs	240 ft-lbs
Above Specifications Are Not to Be Used When the Bolt Is Being Installed With a Bushing.					

Seat Belts Save Lives, Please Wear Your Seat Belt.

Illustration # 5

Note: Cut Out Template Using 'Outside' Edge of Lines as a Guide.

