

## Required Tools List:

- SAE Sockets \ Wrenches
- Diagonal Cutting Pliers
- Adjustable Locking Pliers
- Safety Glasses
- Wheel Chock
- Floor Jack
- Jack Stands
- Torque Wrench



Before beginning installation, read these instructions & enclosed driver's WARNING NOTICE thoroughly & completely. Also affix WARNING decal in passenger compartment in clear view of all occupants. Please refer to Parts List to insure that all parts & hardware are received prior to disassembly of vehicle. If any parts are found to be missing, contact SKYJACKER® Customer Service at 318-388-0816 to obtain needed items. If you have any questions or reservations about installing this product, contact SKYJACKER® Technical Assistance at 318-388-0816.

## **Please Record the Important Measurement Information Below for Reference.**

### **It is very helpful on determining an Accurate Achieved Lift Height Measurement.**

Make sure you park vehicle on a level concrete or asphalt surface. Many times a vehicle is not level (side-to-side) from factory, but is usually not noticed until a lift kit has been installed which makes difference more visible. Using a measuring tape, measure front & rear (both sides) from ground up to center of fender opening above axle.

Driver Side Front: _____ / _____ BEFORE / AFTER	Passenger Side Front: _____ / _____ BEFORE / AFTER
Driver Side Rear: _____ / _____ BEFORE / AFTER	Passenger Side Rear: _____ / _____ BEFORE / AFTER

## Important Notes:

- Lift Kit Height is Based off of Front Lift Height with Less Rear Lift for a More Level Stance.
- If Larger Tires (10% More Than the OEM Diameter) Are Installed, Speedometer Recalibration Will Be Necessary. Contact Your Authorized Skyjacker® Dealer for Details.
- After Installation, a Qualified Alignment Facility Is Required to Align the Vehicle to the OEM Specifications.
- Skyjacker Drop Pitman Arm # SA40 Is Required for Both 2" & 4" Lift Systems.

**Component Box Breakdown:****Part # S24**

Item #	Description	Qty
12X234X6U	1/2 X 2-3/4 X 6 U-BOLT, RD	6
12X318X612U	1/2 X 3-1/8 X 6-1/2 U-BOLT, RD	2
12X334X912U	1/2 X 3-3/4 X 9-1/2 U-BOLT, RD	2
HB-S40	HDWR BAG: FOR S20 / S40	1

**Hardware Bag Breakdown:****Part # HB-S40**

Item #	Description	Qty
12FTN	1/2 NYLON INSERT LOCK NUT	16
SP2028	SPRING EYE BUSHINGS	16
SSSCOUTII	SPRING SLEEVES	8

**Pre-Installation Tips: Install Spring Eye Bushings & Sleeves into Leaf Springs.**

1. Coat Spring Eye Bushings with a water resistant lithium-based grease. Press into each spring eye of Softride Leaf Springs.
2. Coat outside of Spring Sleeve with a water resistant lithium-based grease. Press into spring eye bushings.

**Pre-Installation Tips: Install Shock Boots & Bushings.**

1. Install supplied Shock Boot over Skyjacker Shock. Attach boot to cylinder body with supplied Boot Cable Tie. Remove excess cable tie with diagonal cutting pliers.
2. Coat Hourglass Bushings with a water resistant grease & press into each shock eye.
3. Coat outside of Shock Sleeve with a water resistant lithium-based grease. Press into shock eye bushings.

**Front Installation: Note: Save all factory components & hardware for reuse, unless noted.**

1. With vehicle on flat level ground, set emergency brake & chock rear tires \ wheels.
2. Raise front of vehicle, support frame rails using jack stands at indicated lift points in OEM service manual.
3. Remove front tires \ wheels.
4. Place a floor jack underneath front axle for support. Put a slight load on axle \ jack to prevent axle from moving.
5. Remove OEM front shocks. Disconnect shock upper & lower retaining nuts.  
**Tech Note:** Use adjustable locking pliers or wrench to hold stem \ shaft to loosen nut.

6. Remove OEM U-bolts. Discard U-bolts & hardware. Retain lower OEM U-bolt plate.  
**Tech Note:** Passenger side has a 3-piece u-bolt plate. An OEM spring spacer plate. Remove for reuse.

**NOTE:** If a drop pitman arm was purchased (Skyjacker Drop Pitman Arm # SA40 Is Required for Both 2" & 4" Lift Systems) disconnect tie rod from OEM pitman arm & install new pitman arm. (Refer to separate instructions included with # SA40 drop pitman arm).

**Note: Perform Step 7-9 on One Side at a Time.**

7. Remove OEM front leaf spring. (Note direction of OEM hardware.)  
Loosen front spring eye bolt. Loosen rear spring eye bolt.  
Disconnect spring eye bolts & remove leaf spring.  
**Tech Note:** A helping hand is recommended during removal & installation to keep leaf spring assembly from falling.

8. Install Skyjacker front leaf spring. **Note:** Front up turn spring eye mounts to front shackle. (See Photo # 1)

Attach rear frame mount first, then attach front shackle mount.

Attach spring at rear frame mount with OEM hardware with bolt going from outside-to-inside.

Attach spring at front shackle frame mount with OEM hardware with bolt going from inside-to-outside.

Secure OEM hardware, but **Do Not Completely Tighten** leaf spring hardware at this time. **Tech Note:** To set bushings properly for ride height, these will be tightened once vehicle is on ground with full vehicle weight on tires\wheels.

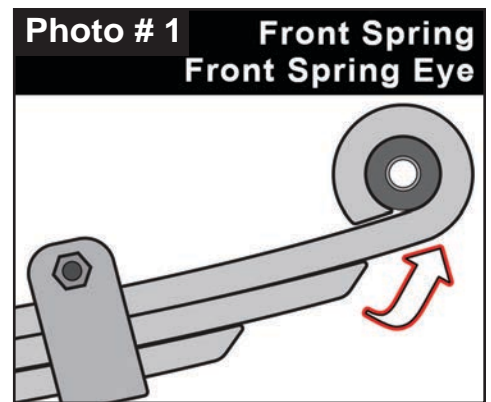

9. Clean spring pads of all debris. Lower axle to mate leaf spring to axle.

**Note:** Be sure that leaf spring center bolt head seats properly into axle pad.

**Tech Note:** On Passenger side, reinstall OEM spring spacer plate between spring & axle.

Install supplied Skyjacker 1/2" U-Bolts over axle down into OEM U-bolt plate. Install supplied 1/2" Nylon Insert Nuts using a 3/4" socket\wrench.

Torque U-bolts evenly using an 'X' crisscross tightening sequence. Torque to 80 ft-lbs.

**Note:** Perform Steps 7-9 on opposite Side at this Time, Then Proceed to Step 10.

10. Install Skyjacker front shock. Install a supplied Washer & Poly Stem Bushing on cylinder body end of Skyjacker shock.

Attach to upper shock tower mount with supplied Bushing, Washer & Lock Nut. (See Photo # 2) Secure, but **Do Not Completely Tighten**.

Install a supplied Washer & Poly Stem Bushing on shaft end of Skyjacker shock.

Attach to lower shock axle mount with OEM hardware. Secure, but **Do Not Completely Tighten** at this time.

11. Install front tires\wheels. Lower vehicle to ground. Torque lugs to OEM service manual specifications.

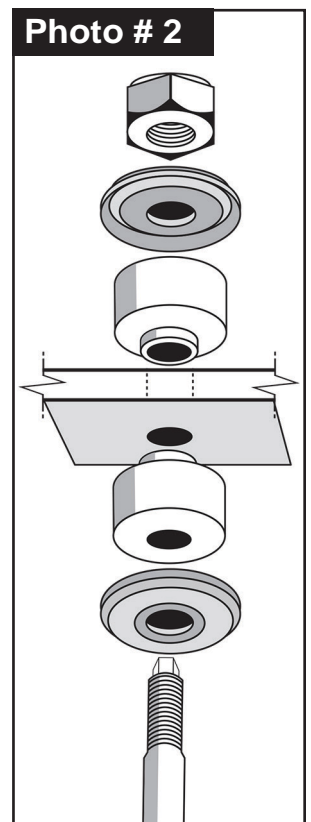

**Rear Installation:** **Note:** Save all factory components & hardware for reuse, unless noted.

1. Chock front tires\wheels. Raise rear of vehicle & support frame rails using jack stands at indicated lift points in OEM service manual.
2. Remove rear tires\wheels.
3. Place a floor jack underneath rear axle for support. Put a slight load on axle\jack to prevent axle from moving.
4. Remove OEM rear shocks. Retain factory mounting hardware for re-use.
5. Remove OEM U-bolts. Discard U-bolts & hardware. Retain lower OEM U-bolt plate.

Note: **Perform Step 6-8 on One Side at a Time.**

6. Remove OEM rear leaf spring. (Note direction of OEM hardware.)  
Loosen forward spring eye bolt. Loosen rear spring eye bolt. Disconnect spring eye bolts & remove leaf spring.

7. Install Skyjacker rear leaf spring. **Note:** Leaf spring end with Spring Clamp attaches to forward frame mount. (See Photo # 3) Attach forward frame mount first, then rear shackle mount.

Attach spring at forward frame mount with OEM hardware with bolt going from outside-to-inside.

Attach spring at rear shackle mount with OEM hardware with bolt going from outside-to-inside.

Secure OEM hardware, but **Do Not Completely Tighten** leaf spring hardware at this time.

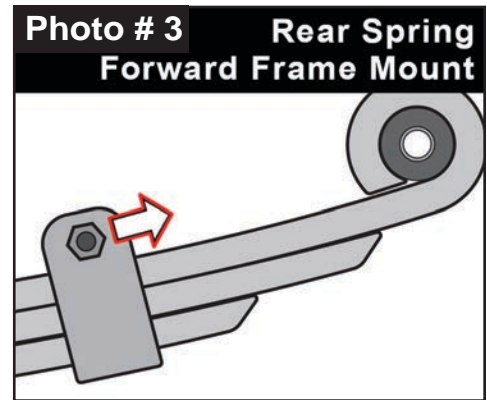

8. Clean spring pads of all debris. Lower axle to mate leaf spring to axle.  
**Note:** Be sure that leaf spring center bolt head seats properly into axle pad.  
**Tech Note:** On Passenger side, reinstall OEM spring spacer plate between spring & axle.  
Install supplied Skyjacker 1/2" U-Bolts over axle down into OEM U-bolt plate. Install supplied 1/2" Nylon Insert Nuts using a 3/4" socket\wrench.  
Torque U-bolts evenly using an 'X' crisscross tightening sequence. Torque to 80 ft-lbs.

Note: **Perform Steps 6-8 on opposite Side at this Time, Then Proceed to Step 9.**

9. Install Skyjacker rear shock with OEM hardware at upper shock tower mount.  
Connect Skyjacker shock at lower axle mount with OEM hardware.  
**Tech Note:** On some models, it may be necessary to space lower shock away from mounting bracket to obtain clearance using standard 1/2" flat washers.  
Secure, but **Do Not Completely Tighten** at this time. To set bushings properly for ride height, these will be tightened once vehicle is on ground with full vehicle weight on tires\wheels.
10. Install rear tires\wheels. Lower vehicle to ground. Torque lugs to OEM service manual specifications.

### **Final Clearance Check & Torque Steps:**

1. Jounce vehicle a couple of times. This will help suspension settle to new ride height. Cycle steering lock-to-lock & check all components for proper operation & clearances. Pay special attention to clearance between tires\wheels, shocks, brake hoses, wiring, etc.
2. **Front Tighten & Torque Sequence.**  
Tighten Shock Bushings until bushing starts to swell slightly.  
Tighten Leaf Springs in this sequence: Rear spring eye bolt. Front shackle eye bolt.  
Torque to 75-85 ft-lbs.
3. **Rear Tighten & Torque Sequence.**  
Tighten Shock Bushings until bushing starts to swell slightly.  
Tighten Leaf Springs in this sequence: Forward spring eye bolt. Rear shackle eye bolt.  
Torque to 75-85 ft-lbs.



## Final Notes:

- After installation is complete, double check that all nuts & bolts are tight. Refer to following chart for proper torque specifications.
- With vehicle placed on ground, cycle steering lock to lock & inspect steering, suspension, brake lines, front & rear drivelines, fuel lines & wiring harnesses for proper operation, tightness & adequate clearance.
- Have headlights readjusted to proper settings.
- Have a qualified alignment center align vehicle to OEM specifications.
- After first 100 miles, check all hardware for proper torque & periodically thereafter.

TORQUE SPECIFICATIONS					
INCH SYSTEM			METRIC SYSTEM		
Bolt Size	Grade 5	Grade 8	Bolt Size	Class 8.8	Class 10.9
5/16	180 in-lbs	240 in-lbs	6MM	60 in-lbs	108 in-lbs
3/8	30 ft-lbs	35 ft-lbs	8MM	216 in-lbs	23 ft-lbs
7/16	45 ft-lbs	60 ft-lbs	10MM	32 ft-lbs	45 ft-lbs
1/2	65 ft-lbs	90 ft-lbs	12MM	55 ft-lbs	75 ft-lbs
9/16	95 ft-lbs	130 ft-lbs	14MM	85 ft-lbs	120 ft-lbs
5/8	135 ft-lbs	175 ft-lbs	16MM	130 ft-lbs	165 ft-lbs
3/4	185 ft-lbs	280 ft-lbs	18MM	170 ft-lbs	240 ft-lbs
The Above Specifications Are Not to Be Used When the Bolt Is Being Installed With a Bushing.					

**Seat Belts Save Lives, Please Wear Your Seat Belt.**



## Single & Dual Steering Stabilizer Kits Available in 3 Different Colors:

Hydro 7000 Series (White), Black MAX Series & Silver 9000 Series.







**JESUS  
FORGIVES  
ROCKS  
DON'T**

## *Jesus Christ Died For You.*

John 3:16

For God so loved the world that He gave His only Son, so that everyone who believes in Him should not perish, but have everlasting life.  
Romans 3:23

For all have sinned; all fall short of God's glorious standard.  
Ephesians 2:8

God saved you by his special favor when you believed. And you can't take credit for this; it is a gift from God.  
Psalms 18:2

The Lord is my Rock, my fortress, and my savior; my God is my Rock, in whom I find protection. He is my shield, the strength of my salvation, and my stronghold.  
Romans 10:9-10

That if you shall confess with thy mouth the Lord Jesus, and shall believe in your heart that God hath raised him from the dead, you shall be saved. For with the heart man believeth unto righteousness; and with the mouth confession is made unto salvation.

### Pray This Simple Prayer:

God, I come to You admitting I have sinned against You and I need you to take control of my life. The Bible says anyone who calls on the name of the Lord will be saved. I am calling on You, Jesus. I ask that You come live in my heart and be the Lord over my life today. I do believe You died on the cross for me and came back to life to give me life! Thank You, Lord Jesus for a new life in You!

Now, go and tell somebody about your new life in Jesus, get a Bible, begin to read it, and go to a Bible believing church.

If you would like someone to pray with you, call Kenneth Copeland Ministries anytime at 800-600-7395.

To listen to commercial free Christian radio on the web, go to [www.887fm.org](http://www.887fm.org)

## *Jesús murió por ti.*

Juan 3:16

"Porque tanto amó Dios al mundo, que dio a su Hijo unigénito, para que todo el que cree en él no se pierda, sino que tenga vida eterna."  
Romanos 3:23

"Pues todos han pecado y están privados de la gloria de Dios."  
Efesios 2:8

"Porque por gracia ustedes han sido salvados mediante la fe; esto no procede de ustedes, sino que es el regalo de Dios."  
Salmos 18:2

"El Señor es mi roca, mi amparo, mi libertador; es mi Dios, el peñasco en que me refugio. Es mi escudo, el poder que me salva, ¡mi más alto escondite!"  
Romanos 10:9-10

"9 Que si confi esas con tu boca que Jesús es el Señor, y crees en tu corazón que Dios lo levantó de entre los muertos, serás salvo. 10 Porque con el corazón se cree para ser justifi cado, pero con la boca se confi esa para ser salvo."

### Ahora dí esta simple oración:

Dios, vengo a Ti y admito que he pecado contra Ti, necesito que tomes el control de mi vida. La Biblia dice que todo aquel que invoca el nombre del Señor escapará con vida. En este momento yo clamo ante Ti, Jesús; te pido que vengas a vivir en mi corazón y que tomes el control de mi vida. ¡Yo creo que tu moriste en la cruz y resucitaste para darme vida! ¡Gracias Señor Jesús, por una nueva vida que tengo en Ti! Amen.

Ahora ve y dile a alguien sobre la nueva vida que tienes en Cristo. Compra una Biblia y empieza a leerla. Busca una Iglesia que cree en la Biblia y hazte parte de esa Iglesia.

Si te gustaría orar con alguien, puedes llamar a este número 800-600-7395

Puedes ir a este sitio de Internet para escuchar música Cristiana sin anuncios, [www.887fm.org](http://www.887fm.org)

**Check out our favorite ministries at:**



[www.innministries.org](http://www.innministries.org)  
[www.familychurch.org](http://www.familychurch.org)  
[www.kcm.org](http://www.kcm.org)