



Skyjacker® LeDuc Series Features & Benefits

- Direct bolt on
- Returnable to stock
- Adjustable ride height
- Increased articulation
- Adjustable secondary spring rate engagement
- Vehicle specific tuned shocks
- Improved stability
- Optional air bump stops
- Made in the USA
- Lifetime guaranteed coil spring



2015 Off-Road Motorsports Hall of Fame Inductee

Skyjacker® is proud to announce our new bolt in Skyjacker® LeDuc Series coil-overs that are tuned and tested by Curt LeDuc with application specific valving for maximum performance on and off-road. This new series of coil-overs can be purchased as kit or just get the coil-over box upgrade for your current Skyjacker® Suspension!

FRONT
JK62FLS • JK62FLSB

REAR
JK62RLS • JK42RLSB / JK62RLSB



OPTIONAL
JKLSAB



Jeep Wrangler 2 & 4 Door & Wrangler Unlimited 4 Door 2007-2016

Kit Ref #	Description	Qty	Part #	Front Shock	Rear Shock	Note
2007-2016 Jeep JK with LeDuc Series Coil Overs						
JK62FLS	3.5-6" Front Coil Over Shocks	1	JK62FLS	Incl.		
JK62FLSB	3.5-6" Front Component Box	1	JK62FLSB			
JK62RLS	3.5-6" Rear Coil Over Shocks	1	JK62RLS		Incl.	
JK42RLSB	3.5-4.5" Rear Component Box	1	JK42RLSB			
JK62RLSB	5-6" Rear Component Box	1	JK62RLSB			
JKLSAB	Optional Front Air Bump Stops	1	JKLSAB			
Notes	Driveshaft Modifications required. Maximum 4.5" backspacing is required. Optional air bump stop kit available. Part #JKLSAB					



JK



With diversity in New Jeep ownership it is no surprise to find Jeep Wrangler JK is sporting a softer rate spring for a softer ride. With this Skyjacker® has created Softride® Coil Kits to maintain OE ride of newer models while still meeting the challenges of off-road terrain of the preceding still available Rock Ready® Coils.

Softride® Coil Kits can still be outfitted on older models to offer the benefits and advantage the superior ride when lifted. Skyjacker offers Softride kits with every available shock option, Hydro, Nitro Gas, Black MAX and M95 Series Monotube with its advanced seal technology for leak down protection you cannot find anywhere else.

Rock Ready® Coil Kits highRear Earlier OE match spring rate is a great choice for any year model with additional weight of bumpers, body armor, skid plates and winches assisting in maintaining lifted height and superior off-road ride



Jeep Wrangler 2 & 4 Door & Wrangler Unlimited 4 Door 2007-2016

Kit Ref #	Description	Qty	Part #	Front Shock	Rear Shock	Note
Jeep 2DR Wrangler & 4DR Wrangler Unlimited 2007-16 2" Poly Spacer Kits - Suggested Tire Size 32" - 33"						
JK20	2" Lift Poly Spacer, Choose Shocks	1	JK20			
	Select Shock Option F&R Shocks (2) each of desired Series					
	Hydro Series Shock with Red Boot, White	2		H7035	H7037	
	Nitro Series Gas Shock with Red Boot, White	2		N8035	N8037	
	Black MAX Performance Shock with Black Boot, Black	2		B8535	B8537	
M95 Monotube Performance Shock, Silver	2		M9535	M9537	4	

Jeep Wrangler Unlimited 4 Door 2007-2016

Jeep 4DR Wrangler Unlimited 2007-16 2.5" Softride Kits - Suggested Tire Size 32" - 35"						
JK25BPHSR	2.5" Lift Softride, No Lower Control Arms, includes (4) Hydro shocks	1	JK25BPHSR	Incl.	Incl.	2,6
JK25BPNSR	2.5" Lift Softride, No Lower Control Arms, includes (4) Nitro shocks	1	JK25BPNSR	Incl.	Incl.	2,6
JK25BPBSR	2.5" Lift Softride, No Lower Control Arms, includes (4) Black MAX shocks	1	JK25BPBSR	Incl.	Incl.	2,6
JK2500BPMSR	2.5" Lift Softride, No Lower Control Arms, includes (4) M95 Monotube	1	JK2500BPMSR	Incl.	Incl.	2,4,6

Jeep 4DR Wrangler Unlimited 2007-16 4" Softride Kits - Suggested Tire Size 35" - 37"

JK40BPHSR	4" Lift Softride, No Lower Control Arms, includes (4) Hydro shocks	1	JK40BPHSR	Incl.	Incl.	1,2,3,5,6
JK40BPNSR	4" Lift Softride, No Lower Control Arms, includes (4) Nitro shocks	1	JK40BPNSR	Incl.	Incl.	1,2,3,5,6
JK40BPBSR	4" Lift Softride, No Lower Control Arms, includes (4) Black MAX shocks	1	JK40BPBSR	Incl.	Incl.	1,2,3,5,6
JK400BPMSR	4" Lift Softride, No Lower Control Arms, includes (4) M95 Monotube	1	JK400BPMSR	Incl.	Incl.	1,2,3,4,5,6

Jeep Wrangler 2 Door 2007-2016

Jeep 2DR Wrangler 2007-16 2" Softride Kits - Suggested Tire Size 32" - 33"						
JK200BPHSR	2" Softride, No Lower Control Arms, includes (4) Hydro shocks	1	JK200BPHSR	Incl.	Incl.	2,6
JK200BPBSR	2" Softride, No Lower Control Arms, includes (4) Black MAX shocks	1	JK200BPBSR	Incl.	Incl.	2,6
JK200BPMSR	2" Softride, No Lower Control Arms, includes (4) M95 shocks	1	JK200BPMSR	Incl.	Incl.	2,4,6

Jeep 2DR Wrangler 2007-16 JK 3.5" Softride Kits - Suggested Tire Size 32" - 35"

JK350BPHSR	3.5" Softride, No Lower Control Arms, includes (4) Hydro shocks	1	JK350BPHSR	Incl.	Incl.	1,2,3,5,6
JK350BPNSR	3.5" Softride, No Lower Control Arms, includes (4) Nitro shocks	1	JK350BPNSR	Incl.	Incl.	1,2,3,5,6
JK350BPBSR	3.5" Softride, No Lower Control Arms, includes (4) Black MAX shocks	1	JK350BPBSR	Incl.	Incl.	1,2,3,5,6
JK350BPMSR	3.5" Softride, No Lower Control Arms, includes (4) M95 Monotube	1	JK350BPMSR	Incl.	Incl.	1,2,3,4,5,6

Notes
1) Requires Pitman Arm JA770 **2)** Optional Control Arm Upgrades available - for Standard Lower Arms add #JKLL24, for Adjustable Lower Flex Arms add #JK24LLX **3)** Optional Long Arm Upgrade add #JK46LA-SX **4)** 9000 Series Silver Steering stabilizer available to match M95 Monotube shock **5)** Requires Exhaust Modification on 2012-16 models **6)** Optional Heavy Duty Steering available (see page 17)

Additional Jeep applications available. See pages 160-175.



JK350BPHSR / JK40BPHSR
Now Includes Adjustable Front Track Bar



JK20



JK2500BPMSR

Jeep Wrangler Unlimited 4 Door 2007-2016 Long Arm Kits



Kit Ref #	Description	Qty	Part #	Front Shock	Rear Shock	Note	
Jeep 4DR Wrangler 2007-16 JK 4" Rock Ready Long Arm Kit - Suggested Tire Size 35"- 37"							
JK40LAK-SX	Wrangler JK Long Arm Box 3.5-7"	1	JK46LA-SX			5,6	
	Wrangler JK Long Arm Box 3.5-5"	1	JK40LA				
	Wrangler JK Rock Ready Front Coils 4"	1	JK40F				
	Wrangler JK Rock Ready Rear Coils 4"	1	JK40R				
	Required Pitman Arm Jeep JK	1	JA770				
	Select a Shock Option F&R Shocks (2) each of desired Shock Series						
	Hydro Series Shock with Red Boot, White	2		H7065	H7067		
	Nitro Series Gas Shock with Red Boot, White	2		N8065	N8067		
	Black MAX Performance Shock with Black Boot, Black	2		B8565	B8567		
	M95 Monotube Performance Shock, Silver	2		M9565	M9567	4	

Kit Ref #	Description	Qty	Part #	Front Shock	Rear Shock	Note	
Jeep 4DR Wrangler 2007-16 JK 6" Rock Ready Long Arm Kit - Suggested Tire Size 35"- 37"							
JK60LAK-SX	Wrangler JK Long Arm Box 3.5-7"	1	JK46LA-SX			5,6	
	Wrangler JK Long Arm Box 5-7"	1	JK60LA				
	Wrangler JK Rock Ready Front Coils 6"	1	JK60F				
	Wrangler JK Rock Ready Rear Coils 6"	1	JK60R				
	Required Pitman Arm Jeep JK	1	JA770				
	Select a Shock Option F&R Shocks (2) each of desired Shock Series						
	Hydro Series Shock with Red Boot, White	2		H7075	H7087		
	Nitro Series Gas Shock with Red Boot, White	2		N8075	N8087		
	Black MAX Performance Shock with Black Boot, Black	2		B8575	B8587		
	M95 Monotube Performance Shock, Silver	2		M9575	M9587	4	
Notes	4) 9000 Series Silver Steering stabilizer available to match M95 Monotube shock 5) Exhaust Modification required 2012-16 Part # JK36ESK 6) Optional #JK717SK Heavy Duty Complete Steering, Tie Rod and Drag Link available						

Jeep Wrangler 2 Door 2007-2016 Long Arm Kits

Kit Ref #	Description	Qty	Part #	Front Shock	Rear Shock	Note	
Jeep 2DR Wrangler 2007-16 3.5" Rock Ready Kit JK Long Arm - Suggested Tire Size 35"- 37"							
JK35LAK-SX	Wrangler JK Long Arm Box 3.5-7" Arms Brackets	1	JK46LA-SX			5,6	
	Wrangler JK Long Arm Box 3.5-5" Stainless Brake lines Disconnects	1	JK40LA				
	Wrangler JK Front Coils 3.5"	1	JK25F				
	Wrangler JK Rear Coils 3.5"	1	JK25R				
	Required Pitman Arm Jeep JK	1	JA770				
	Select a Shock Option F&R Shocks (2) each of desired Shock Series						
	Hydro Series Shock with Red Boot, White	2		H7065	H7067		
	Nitro Series Gas Shock with Red Boot, White	2		N8065	N8067		
	Black MAX Performance Shock with Black Boot, Black	2		B8565	B8567		
	M95 Monotube Performance Shock, Silver	2		M9565	M9567	4	

Kit Ref #	Description	Qty	Part #	Front Shock	Rear Shock	Note	
Jeep 2DR Wrangler 2007-16 Long Arm 5" Rock Kits JK Long Arm 7" Rock Ready Coils - Suggested Tire Size 35"- 37"							
JK40LAK-SX	Wrangler JK Long Arm Box 3.5-7" Arms Brackets	1	JK46LA-SX			5,6	
	Wrangler JK Long Arm Box 5-7" Stainless Brake lines Disconnects	1	JK60LA				
	Wrangler JK Front Coils 5"	1	JK40F				
	Wrangler JK Rear Coils 5"	1	JK40R				
	Required Pitman Arm Jeep JK	1	JA770				
	Select a Shock Option F&R Shocks (2) each of desired Shock Series						
	Hydro Series Shock with Red Boot, White	2		H7075	H7087		
	Nitro Series Gas Shock with Red Boot, White	2		N8075	N8087		
	Black MAX Performance Shock with Black Boot, Black	2		B8575	B8587		
	M95 Monotube Performance Shock, Silver	2		M9575	M9587	4	
Notes	5) Exhaust Modification required 2012-16 Part # JK36ESK 6) JK717SK Heavy Duty Complete Steering, Tie Rod and Drag Link available						

Jeep Wrangler 2 Door & Wrangler & Unlimited 4 Door 2007-2016

Kit Ref #	Description	Qty	Part #	Front Shock	Rear Shock	Note
Options Jeep Wrangler & Wrangler & Unlimited 2007-2016						
Wrangler JK Options	Front/Rear Non-Adjustable Control Arms Jeep Wrangler 2007-15 2.5-4" Lift	1	JKLL24			
	Front/Rear Adjustable Flex Control Arms Jeep Wrangler 2007-15 2.5-4" Lift	1	JK24LLX			
	Long Arm Upgrade 3.5-7" Lift Jeep Wrangler 2007-2015	1	JK46LA-SX			
	Front Upper Adjustable Control Arms	1	JKULF26-SX			
	Rear Upper Adjustable Control Arms	1	JKULR26-SX			
	Front Adjustable Track Bar 2007-15 Jeep Wrangler JK 3.5-7" Only	1	FTBA45			
	Rear Adjustable Track Bar 2007-15 Jeep Wrangler JK 3.5-7" Only	1	RTBA45			
	Heavy Duty JK Ball Joints Upper and Lower, Both sides	1	JK2717B			
	Heavy Duty Tie Rod with Ends	1	JK717TR			
	Heavy Duty Drag Link with Ends	1	JK717DL			
	OEM Steering Stabilizer Kit, WHITE w/Red Boot	1	7003			
	OEM Steering Stabilizer Kit, BLACK w/Black Boot	1	8003			
	OEM Steering Stabilizer Kit, SILVER w/Black Boot	1	9003			
	Dual Steering Stabilizer Kit, WHITE	1	7203			
	Dual Steering Stabilizer Kit, BLACK	1	8203			
	Dual Steering Stabilizer Kit, SILVER	1	9203			
	Front Coil Spring Isolator Pads 3/4", lift Pair	1	JKFPS75			
	Rear Coil Spring Isolator Pads 3/4", lift Pair	1	JKRPS75			
	Grab Handles, 3" BLACK	1	RRGH30RP-K			
	Grab Handles, 3" RED	1	RRGH30RP-R			
Control arm Cam Bolt Kit pair	1	CAM700				
JK 3.6L Exhaust Spacer Kit, For 12-16 models only	1	JK36ESK				

Additional Jeep applications available. See pages 160-175.



JK60LAK-SX

Skyjacker® Rock Ready® ball joint load distribution design

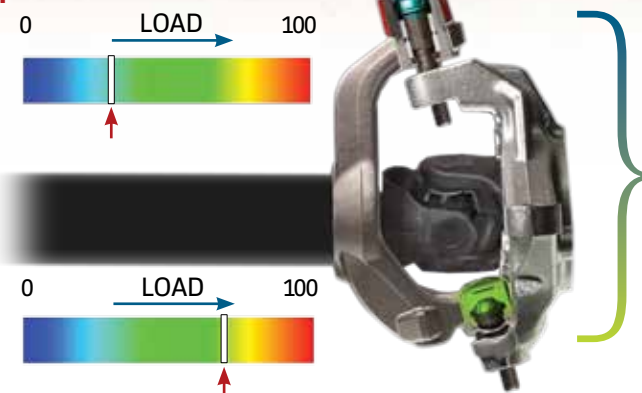

The Skyjacker® Rock Ready® ball joint design shares the load between both the lower and upper ball joints significantly lengthening the life of both joints.

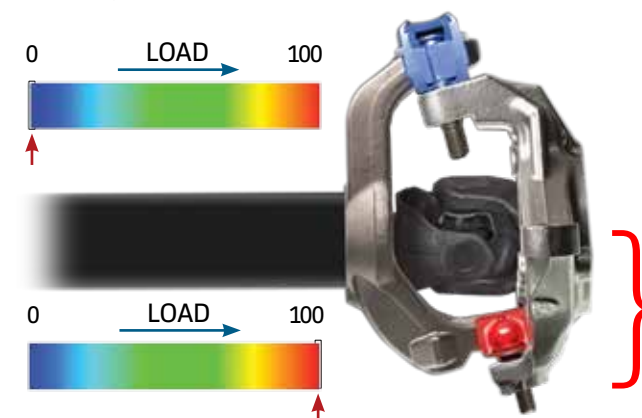

The OE ball joint design consist of a weight carrying lower ball joint and a follower upper ball joint. In this design the lower ball joint carries the full weight and road force of the Jeep and the upper ball joint is only a pivot point that controls lateral movement.

Upper Ball Joint, USA-made tapered roller bearing carries axial and radial loads. Polyurethane wipe seal prevents contamination - mounted internally to prevent tearing and friction between knuckle and ball joint face

Lower Ball Joint, HEXAD Grease System - 6 equally spaced grease grooves evenly distributes grease; With every turn of the wheel, grease is spread in between the two wear surfaces

32MM powdered metal bearing replaces the undersized OE plastic bearing, increasing load carrying capacity

Allows clearance for RCV axles without modification

MADE IN THE USA

Heavy Duty Load Carrying Upper Ball Joint

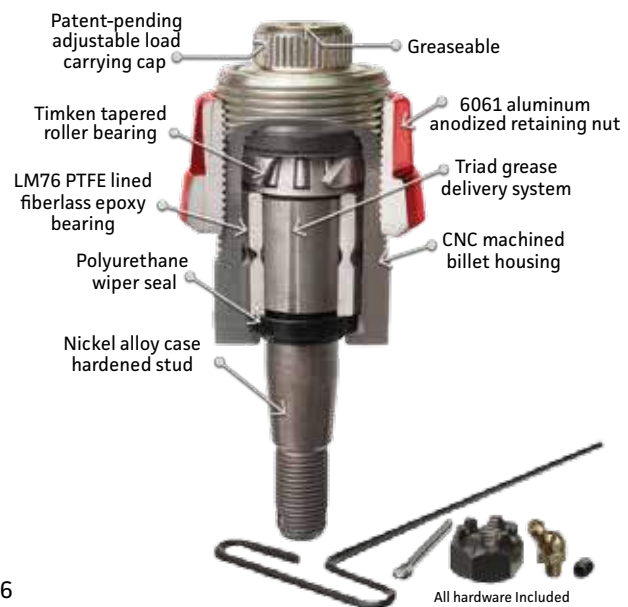

Heavy Duty Lower Ball Joint

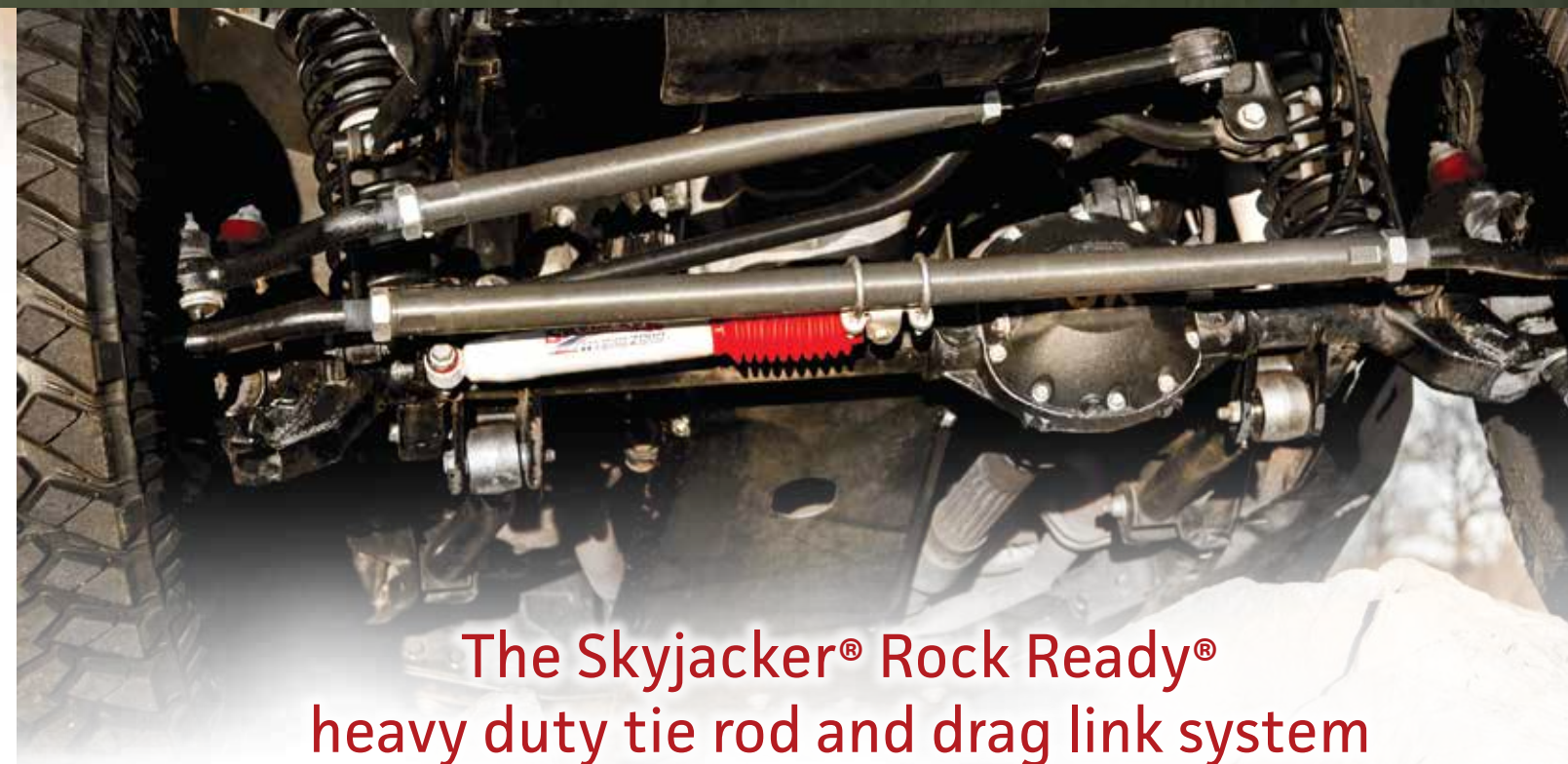

The Skyjacker® Rock Ready® heavy duty tie rod and drag link system



The Skyjacker® Rock Ready® heavy duty steering system for all Jeep Wrangler JK models features 1 3/4" diameter .281 wall 1026 DOM tie rod and drag link tubes, 1 1/4" threaded forged steel greasable tie rod ends, as well as a new steering stabilizer bracket. The massive tie rod cartridges thread into the tie rod end body, so they may be replaced without purchasing the entire rod end which saves cost. The same threaded tie rod cartridge is used at all 4 points so only one spare would have to be carried. Tie rod and drag link tubes feature wrench flats machined into them for ease of adjustment. This unit is a direct replacement for the OEM parts. No modifications or machining to any part of the vehicle is necessary. Tie rod and drag links can be purchased as a set or individually.

If a flipped draglink is desired, the tie rod cartridge may be unscrewed from the rod end body and screwed in from the other side. **NOTE: Flipping the drag link will require retapering the tie rod end hole from the top side of the knuckle.**

MADE IN THE USA



TJ

Skyjacker has the right combination in suspension, the lift, the look and the performance all at the right price. Not sure how extreme to go, limited budget no worries. Make your economical choice without sacrificing quality and upgrade later with Skyjacker long arm upgrades and control arm upgrades.



Jeep Wrangler TJ 1997-2006						
Kit Ref #	Description	Qty	Part #	Front Shock	Rear Shock	Note
Jeep Wrangler TJ & Wrangler Unlimited LJ 1997-06 2" Poly Spacer Kit - Suggested Tire Size - 32"						
TJ20	2" Kit Poly Spacer 1997-06 Jeep Wrangler TJ	1	TJ20			
	Select a Shock Option F&R Shocks (2) each of desired Shock Series					
	Hydro Series Shock with Red Boot, White	2		H7016	H7018	
	Nitro Series Gas Shock with Red Boot, White	2		N8016	N8018	
	Black MAX Performance Shock with Black Boot, Black	2		B8516	B8518	
	M95 Monotube Performance Shock, Silver	2		M9516	M9518	
Jeep Wrangler TJ & Wrangler Unlimited LJ 1997-06 2.5" Kit No Lower Link Arms - Suggested Tire Size - 31"-32"						
TJ25BPH	2.5" Jeep Wrangler No Lower Arms, includes (4) Hydro shocks	1	TJ25BPH	Incl.	Incl.	
Jeep Wrangler TJ & Wrangler Unlimited LJ 1997-06 3" Kit No Lower Link Arms - Suggested Tire Size - 31"-33"						
TJ30BPH	3" Jeep Wrangler No Lower Arms, includes (4) Hydro shocks	1	TJ30BPH	Incl.	Incl.	
Jeep Wrangler TJ & Wrangler Unlimited LJ 1997-02 4" Kit Fixed Lower Arms - Suggested Tire Size - 33"						
TJ401BPH	4" Jeep Wrangler with Standard Lower Arms, includes (4) Hydro shocks	1	TJ401BPH	Incl.	Incl.	13
TJ401BPB	4" Jeep Wrangler with Standard Lower Arms, includes (4) Black MAX shocks	1	TJ401BPB	Incl.	Incl.	13
TJ401BPM	4" Jeep Wrangler with Standard Lower Arms, includes (4) M95 Monotube	1	TJ401BPM	Incl.	Incl.	13
Jeep Wrangler TJ & Wrangler Unlimited LJ 1997-02 4" Kit Adjustable Lower Flex Arms - Suggested Tire Size - 33"						
TJ401BPHX	4" Jeep Wrangler w/Adj Flex Lower Arms, includes (4) Hydro shocks	1	TJ401BPHX	Incl.	Incl.	13
Jeep Wrangler TJ & Wrangler Unlimited LJ 2003-06 4" Kit Fixed Lower Arms - Suggested Tire Size - 33"						
TJ403BPH	4" Jeep Wrangler with Standard Lower Arms, includes (4) Hydro shocks	1	TJ403BPH	Incl.	Incl.	13
TJ403BPB	4" Jeep Wrangler with Standard Lower Arms, includes (4) Black MAX shocks	1	TJ403BPB	Incl.	Incl.	13
TJ403BPM	4" Jeep Wrangler with Standard Lower Arms, includes (4) M95 Monotube	1	TJ403BPM	Incl.	Incl.	13
Jeep Wrangler TJ & Wrangler Unlimited LJ 2003-06 4" Kit Adjustable Lower Flex Arms - Suggested Tire Size - 33"						
TJ403BPHX	4" Jeep Wrangler w/Adj Flex Lower Arms, includes (4) Hydro shocks	1	TJ403BPHX	Incl.	Incl.	13
Notes	10) Optional 1997-06 High Clearance Skid add #SP176 *97-02 order #SPS28M Mount. 03-06 Auto Only 11) Non Rubicon Models Require Slip Yoke Eliminator #RR231 and CV Driveshaft TJRS 12) Exhaust Modifications to Crossover Pipe required 13) Optional Long Arm Upgrade 3.5-6" Lift Jeep Wrangler 1997-2006 #TJ40RRX					

Additional Jeep applications available. See pages 160-175.



TJ401BPM



TJ401BPH

Jeep Wrangler TJ 1997-2006 Long Arm Kits

Kit Ref #	Description	Qty	Part #	Front Shock	Rear Shock	Note
Jeep Wrangler TJ 1997-06 6" Kit Rock Ready Long Arm Lower Only Adjustable Control Arms - Suggested Tire Size - 35"						
TJ60RR1K	6" Rock Ready Long Arm Adjustable Uppers & Lovers 1997-06 Wrangler TJ	1	TJ68RRX			10,11,12
	6" Rock Ready Long Arm Adjustable Uppers & Lovers 1997-06 Wrangler TJ	1	TJ60RR1			
	6" Front Coils Pair Wrangler TJ	1	TJ60F			
	6" Rear Coils Pair Wrangler TJ	1	TJ60R			
	Hydro Series Shock with Red Boot, White	2		H7049	H7063	
	Nitro Series Gas Shock with Red Boot, White	2		N8049	N8063	
	Black MAX Performance Shock with Black Boot, Black	2		B8549	B8563	
	M95 Monotube Performance Shock, Silver	2		M9549	M9563	
Jeep Wrangler TJ 1997-06 6" Kit Rock Ready Long Arm Upper & Lower Adjustable Control Arms - Suggested Tire Size - 35"						
TJ60RR2K	6" Rock Ready Long Arm Adjustable Uppers & Lovers 1997-06 Wrangler TJ	1	TJ68RRX			10,11,12
	6" Rock Ready Long Arm Adjustable Uppers & Lovers 1997-06 Wrangler TJ	1	TJ60X2			
	6" Front Coils Pair Wrangler TJ	1	TJ60F			
	6" Rear Coils Pair Wrangler TJ	1	TJ60R			
	Hydro Series Shock with Red Boot, White	2		H7049	H7063	
	Nitro Series Gas Shock with Red Boot, White	2		N8049	N8063	
	Black MAX Performance Shock with Black Boot, Black	2		B8549	B8563	
	M95 Monotube Performance Shock, Silver	2		M9549	M9563	
Notes	10) Optional 1997-06 High Clearance Skid add SP176 *97-02 order SPS28M Mount. 03-06 Auto Only 11) Non Rubicon Models Requires Slip Yoke Eliminator RR231 and CV Driveshaft TJRS 12) Exhaust Modifications to Crossover Pipe required					

Additional Jeep applications available. See pages 160-175.



TJ60RR1K



TJ40RR1K



SP176



TJRS



RR231

Jeep Wrangler TJ 1997-2006

Kit Ref #	Description	Qty	Part #	Front Shock	Rear Shock	Note
Options Jeep Wrangler & Wrangler & Unlimited 2007-2015						
Wrangler TJ Options	Long Arm Upgrade 3.5-6" Lift Jeep Wrangler 1997-2006	1	TJ40RRX			11,12
	High Clearance Transfer Case Skid Plate (03-06 TJ Models)	1	SP176			10
	Upper Front & Rear Adjustable Control Arm Jeep Wrangler TJ LJ 1997-2006	1	JUL48SFX			
	Slip Yoke Eliminator	1	RR231			
	CV Driveshaft 2003-06 Auto & 6cyl with Dana 35 rear axle & OEM Skid	1	TJRS			
	CV Driveshaft 1997-03 5 Speed Manual & 6cyl Dana 35 rear axle & OEM Skid	1	TJRS			
	Front Upper Adjustable Control Arms	1	JULF24-FX			
	Rear Upper Adjustable Control Arms	1	JULR24-SX			
	Control arm Cam Bolt Kit pair	1	CAM500			
	Extended Poly Bump stop Front or Rear 1997-06 Wrangler TJ LJ 2.5" pair	1	BP50			
	Bump stop extensions 2" Front or Rear coil pad mount 1997-06 Wrangler TJ LJ	1	BPS20			
	Bump stop extensions 3" Front or Rear coil pad mount 1997-06 Wrangler TJ LJ	1	BPS30			
	3/4" Coil Spring Isolator Pads, Pair 1997-06 Wrangler TJ LJ	1	SIP275			
	OEM Replacement Steering Stabilizer 1997-06 Wrangler TJ LJ	1	7009			
	Rock Ready Steering Box Skid Plate 1997-06 Wrangler TJ LJ	1	RRSP20			
	NP231 Transfer Case Shifter Relocation Bracket 1997-06 Wrangler TJ LJ	1	JSRB231A			
	Front Stainless Steel DOT Brake Lines 4"-8" Lift/Pair 1997-06 Wrangler TJ LJ	1	FBL44			
	Rear Stainless Steel DOT Brake Line 4"-8" Lift/Single 1997-06 Wrangler TJ LJ	1	RBL98			
	High Capacity Trans Pan w/Drain Plug 1987-02 Wrangler with 999 Auto	1	OPA999			
	Heavy Duty Tie Rod Tube 1997-06 Wrangler TJ LJ	1	TR300			
	Rear Shock Relocation Bracket Jeep Wrangler TJ Only 1997-2006	1	TJRSB10			
	1" Body Lift Complete all parts replacement set TJ Only 1997-2006	1	SS951P			
	1" Body Lift Top section replace TJ Only 1997-2006	1	SS951			
	2" Body Lift Top section replace TJ Only 1997-2007	1	SS952			
	Rock Lock Front Selectable Front Sway Bar	1	JFSBA10			
	Heavy Duty Adjustable Rear Sway Bar	1	RSBA410			
Notes	10) Optional 1997-06 High Clearance Skid add SP176 *97-02 order SPS28M Mount. 03-06 Auto Only 11) Non Rubicon Models Requires Slip Yoke Eliminator RR231 and CV Driveshaft TJRS 12) Exhaust Modifications to Crossover Pipe required					



FBL44

RBL98

RRSP20

OPA999



RSBA410



JSRB231A



CAM500

XJ



Jeep



Shown in red for display only.

4.5", 6" and 8" Rock Ready® Cherokee XJ System Skyjacker® Suspensions offers Jeep Cherokee XJ owners the ultimate in suspension technology. Whether you're twisting it up on the Red Rock of Moab or conquering the South American jungles of Peru, this is the suspension system you need.



Shown in red for display only.



Jeep Cherokee XJ 1984-2001

Kit Ref #	Description	Qty	Part #	Front Shock	Rear Shock	Note
Jeep Cherokee 1984-01 2" Kit Poly Spacer Rear Lift Shackles - Suggested Tire Size - 30"						
XJ20	2" Poly with Rear Lift Shackles Comp Box, 2" 1984-01 Jeep Cherokee XJ	1	XJ20			
	Select a Shock Option F&R Shocks (2) each of desired Shock Series					
	Hydro Series Shock with Red Boot, White	2		H7016	H7018	
	Nitro Series Gas Shock with Red Boot, White	2		N8016	N8018	
	Black MAX Performance Shock with Black Boot, Black	2		B8516	B8518	
	M95 Monotube Performance Shock, Silver	2		M9516	M9518	
Jeep Cherokee 1984-01 3" Kit Sport Series Add-a-Leaf with Standard Control Arms - Suggested Tire Size - 31"						
JC301K	3" Standard Lower Arm Component Box Cherokee	1	JC30			
	Front Coils Jeep 3"	1	JC30F			
	Rear Add A Leafs, Pair	1	R3136			
	Select a Shock Option F&R Shocks (2) each of desired Shock Series					
	Hydro Series Shock with Red Boot, White	2		H7016	H7018	
	Nitro Series Gas Shock with Red Boot, White	2		N8016	N8018	
	Black MAX Performance Shock with Black Boot, Black	2		B8516	B8518	
	M95 Monotube Performance Shock, Silver	2		M9516	M9518	
Jeep Cherokee 1984-01 3" Kit, Sport Series Add-a-Leaf, No Control Arms, Hydro Shocks - Suggested Tire Size - 31"						
JC31BKH	Cherokee 3" Coils Add-a-Leaf No Arms, includes (4) Hydro shocks	1	JC31BKH	Incl.	Incl.	
Jeep Cherokee 1984-01 3" Kit, Rear Leaf Springs, No Control Arms, Hydro Shock with Dana 35 Axle - Suggested Tire Size - 31"						
JC315BKSH	Cherokee 3" Coils Rear Leafs No Arms, (4) Hydro shocks, Dana 35 Axle	1	JC315BSH	Incl.	Incl.	
	Rear Leaf Springs Cherokee	2	JC25RSB			
Jeep Cherokee 1984-01 3" Kit, Rear Leaf Springs, No Control Arms, Hydro Shock with Chrysler 8.25 Axle - Suggested Tire Size - 31"						
JC318BKSH	Jeep Cherokee 3" Coils Rear Leaf No Arms, (4) Hydro shocks, 8.25 Axle	1	JC318BSH	Incl.	Incl.	
	Rear Leaf Springs Cherokee	2	JC25RSB			
Jeep Cherokee 1984-01 4.5" Kit, w/Rear Add-a-Leaf Front Shackle Standard Arm - Suggested Tire Size - 32"						
JC451K	Front Coil Springs, Pair	1	JC45F			16
	Component Box Cherokee 4.5" Non-Adjustable Upper Rear Lower Flex Arms	1	JC45			
	Rear Add A Leafs, Pair	1	R3136			
	Hydro Series Shock with Red Boot, White	2		H7025	H7028	
	Nitro Series Gas Shock with Red Boot, White	2		N8025	N8028	
	Black MAX Performance Shock with Black Boot, Black	2		B8525	B8528	
	M95 Monotube Performance Shock, Silver	2		M9525	M9528	
Jeep Cherokee 1984-01 4.5" w/Rear Add-a-Leaf Front Shackle Adjustable Flex Arm - Suggested Tire Size - 32"						
JC451K-SVX	Front Coil Springs, Pair	1	JC45F			16
	Component Box Cherokee 4.5" Adjustable Upper Rear Lower Flex Arms	1	JC45-SVX			
	Rear Add A Leafs, Pair	1	R3136			
	Hydro Series Shock w/Red Boot	2		H7025	H7028	
	Nitro Series Shock w/Red Boot	2		N8025	N8028	
	Black MAX Performance Shock with Black Boot, Black	2		B8525	B8528	
	M95 Monotube Shock, Silver	2		M9525	M9528	
Notes	16) Transfer Lowering Required 17) Requires Slip Yoke Eliminator RR231 and CV Driveshaft					

Additional Jeep applications available. See pages 160-175.



JC31BKH



XJ20



JC315BKSH

Jeep Cherokee XJ 1984-2001

Kit Ref #	Description	Qty	Part #	Front Shock	Rear Shock	Note
Jeep Cherokee 1984-01 6" Long Arm w/Rear Leafs Springs w/Hydro Shock with Dana 35 Rear - Suggested Tire Size - 33"						
JC605BKSH	Front Coil Springs	1	JC60F	Incl.	Incl.	16,17
	Comp Box Cherokee Long Arm 6" w/Leafs	1	JC60RRX			
	Comp Box Cherokee Long Arm 6" w/Leafs, (4) Hydro shocks, Dana 35 Axle	1	JC605BSH			
	Rear Leaf Spring	2	JC55RSB			
Jeep Cherokee 1984-01 6" Long Arm w/Rear Leafs Springs w/Hydro Shock with Chrysler 8.25 Axle - Suggested Tire Size - 33"						
JC608BKSH	Front Coil Springs	1	JC60F	Incl.	Incl.	16,17
	Comp Box Cherokee Long Arm 6" w/Leafs	1	JC60RRX			
	Comp Box Cherokee Long Arm 6" w/Leafs, (4) Hydro shocks, 8.25 Axle	1	JC608BSH			
	Rear Leaf Spring	2	JC55RSB			
Notes	16) Transfer Lowering Required 17) Requires Slip Yoke Eliminator RR231 and CV Driveshaft					
Options Jeep Cherokee 1984-2001						
Jeep Cherokee Options	Transfer Case Lowering Kit (Short Arm/OE Arm Kits)	1	TCL30			
	Transfer Case Lowering Kit (Long Arm Kits)	1	TCL32			
	3/4" Coil Spring Isolator Pads, Pair	1	SIP275			
	Rear Shackles Jeep Cherokee 1988-2001, 1" lift	1	SH130			
	Heavy Duty Tie Rod Tube (1991 - 2001 Models)	1	TR300			
	Transfer Case Lowering Kit (JC451K & JC451K-SVX Kits)	1	TCL30			
	Transfer Case Lowering Kit (JC455RR2KS & JC458RR2KS Systems)	1	TCL32			
	Slip Yoke Eliminator Kit (1984 - 2001 Models with NP231 Transfer Case)	1	RR231			
Notes	16) Transfer Lowering Required 17) Requires Slip Yoke Eliminator RR231 and CV Driveshaft					

Additional Jeep applications available. See pages 160-175.

3" Jeep Cherokee Standard Kits & Systems Skyjacker® Suspensions offers a 3" Kit with rear Add-A-Leafs, or a 3" System with Softride® rear springs. Both Kits feature Softride® front coil springs, track bar relocation bracket, greaseable lower control arms and 2-stage rear Softride® leaf springs.

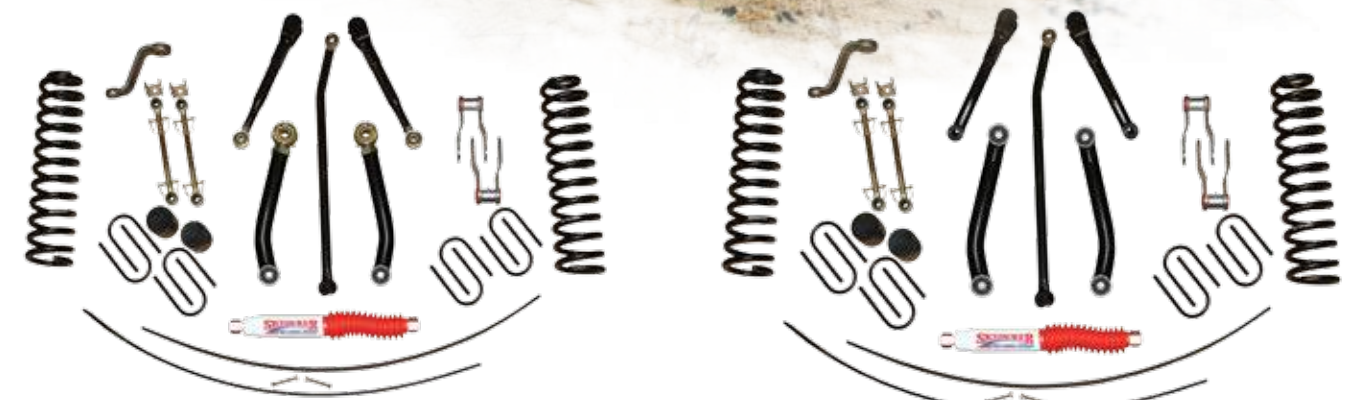

JC451K-VX

JC451K



TR300



SH130



TCL30



6" 84-01 Cherokee Long-Arm Suspension

YJ

2" and 4" Systems These versatile Systems consist of front and rear Softride® multi-leaf springs and e-coated U-Bolts. The 4" features rear track bar brackets. The 2" and 4" systems are the perfect lifts for the less extreme off road driver. Complete your YJ today by ordering one of these versatile systems.



2.5" and 4" Military Wrap You will want to utilize the performance of the Double Military Wrap Leaf Springs to gain torque control, main leaf protection and exceptional ride quality. These durable, long lasting units have larger spring eyes at both ends. These larger eyes contain larger bushings designed for strength & longevity.



Jeep Wrangler YJ 1987-1995						
Kit Ref #	Description	Qty	Part #	Front Shock	Rear Shock	Note
Jeep Wrangler 1987-95 YJ 2.5" Includes Hydro Shocks Sport Series Leaf Springs - Suggested Tire Size - 31"						
YJ21BKH	Front Leaf Spring 2.5"	2	YJ20FSB			
	Rear Leaf Spring 2.5"	2	YJ20RSB			
	Jeep Wrangler YJ 1987-95 2.5" Component Box, includes (4) Hydro shocks	1	YJ21BH	Incl.	Incl.	
Jeep Wrangler 1987-95 YJ 2.5" Softride Series Leaf Springs - Suggested Tire Size - 31"						
YJ20K	Front Leaf Spring 2.5"	2	YJ20FS			
	Rear Leaf Spring 2.5"	2	YJ20RS			
	Jeep Wrangler YJ 1987-95 2.5" Comp Box	1	YJ20			
Select a Shock Option F&R Shocks (2) each of desired Shock Series						
	Hydro Series Shock with Red Boot, White	2		H7056	H7023	
	Nitro Series Gas Shock with Red Boot, White	2		N8056	N8023	
	Black MAX Performance Shock with Black Boot, Black	2		B8556	B8523	
	M95 Monotube Performance Shock, Silver	2		M9556	M9523	
Jeep Wrangler 1987-95 YJ 4" Includes Hydros Shock Sport Series Leaf Springs - Suggested Tire Size - 33"						
YJ41BKH	Front Leaf Spring 4"	2	YJ40FSB			20
	Rear Leaf Spring 4"	2	YJ40RSB			
	Jeep Wrangler YJ 1987-95 4" Component Box, includes (4) Hydro shocks	1	YJ41BH	Incl.	Incl.	
Jeep Wrangler 1987-95 YJ 4" Softride Series Leaf Springs - Suggested Tire Size - 33"						
YJ40K	Front Leaf Spring 4"	2	YJ40FS			17,18,19,20
	Rear Leaf Spring 4"	2	YJ40RS			
	Jeep Wrangler YJ 1987-95 4" Component Box	1	YJ40			
Select a Shock Option F&R Shocks (2) each of desired Shock Series						
	Hydro Series Shock with Red Boot, White	2		H7059	H7088	
	Nitro Series Gas Shock with Red Boot, White	2		N8059	N8088	
	Black MAX Performance Shock with Black Boot, Black	2		B8559	B8588	
	M95 Monotube Performance Shock, Silver	2		M9559	M9588	

Additional Jeep applications available. See pages 160-175.



YJ20K



YJ21BKH



YJ60MK

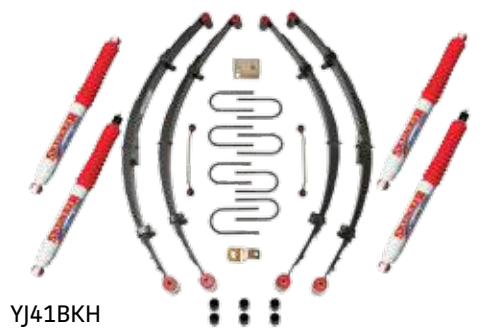

YJ41BKH



Jeep Wrangler YJ 1987-1995							
Kit Ref #	Description	Qty	Part #	Front Shock	Rear Shock	Note	
YJ45K	Front Leaf Spring 4"	2	YJ45FS			18,19,20	
	Rear Leaf Spring 4"	2	YJ45RS				
	Jeep Wrangler YJ 1987-95 4" Component Box	1	YJ45				
	Select a Shock Option F&R Shocks (2) each of desired Shock Series						
	Hydro Series Shock with Red Boot, White	2			H7059	H7088	
	Nitro Series Gas Shock with Red Boot, White	2			N8059	N8088	
	Black MAX Performance Shock, with Black Boot, Black	2			B8559	B8588	
M95 Monotube Performance Shock, Silver	2			M9559	M9588		
Jeep Wrangler 1987-95 YJ 6" Monolinier Single Leaf Springs - Suggested Tire Size - 35"							
YJ60MK	6" Lift Monolinier Leafs 1987-1995	1	YJ60M			17,18,20	
Notes	17) Requires Slip Yoke Eliminator RR231 & CV Driveshaft 18) YJ5LK 5th Link Traction Bar Recommended 19) Transfer Case Lower Kit Required 20) Drop Pitman Arm Part #JA750 Required						

Jeep Wrangler 1987-95 YJ 2.5" Rock Ready Military Wrap Series Leaf Springs - Suggested Tire Size - 31"							
YJ25K	Front Leaf Spring 2.5"	2	YJ25FS				
	Rear Leaf Spring 2.5"	2	YJ25RS				
	Jeep Wrangler YJ 1987-95 2.5" Component Box	1	YJ25				
	Select a Shock Option F&R Shocks (2) each of desired Shock Series						
	Hydro Series Shock with Red Boot, White	2			H7056	H7023	
	Nitro Series Gas Shock with Red Boot, White	2			N8056	N8023	
	Black MAX Performance Shock, with Black Boot, Black	2			B8556	B8523	
M95 Monotube Performance Shock, Silver	2			M9556	M9523		

Options Jeep Wrangler YJ 1987-95						
Jeep Wrangler YJ 1987-95 Options	Drop Pitman Arm Power Steering	1	JA750			
	HD OEM Steering Stabilizer White w/Red Boot	1	7009			
	HD OEM Steering Stabilizer Silver w/Black Boot	1	9009			
	Dual Steering Stabilizer White w/Red Boot	1	7200			
	Dual Steering Stabilizer Silver w/Black Boot	1	9200			
	Front & Rear Complete Frame Shackle Bushings Wrangler YJ 1987-95	1	SE3YJ			
	1" Lift Shackles Front Greasable Wrangler YJ 1987-95	1	SH2545F			
	1" Lift Shackles Rear Greasable Wrangler YJ 1987-95	1	SH2545R			
	High Capacity Transmission Pan w/Drain Plug 1987-95 Wrangler w/999 Auto	1	OPA999			
	Traction Bar 5th Link w/Cross member 1987-95 Wrangler	1	YJ5LK			
	Traction Bar 5th Link w/o "NO" Cross member 1987-95 Wrangler	1	TB500K			
	1" Body Lift Complete polyurethane replacement set 1987-95 Wrangler	1	SS931P			
	1" Body Lift Top section replace 1987-95 Wrangler	1	SS931			

Additional Jeep applications available. See pages 160-175.



YJ5LK

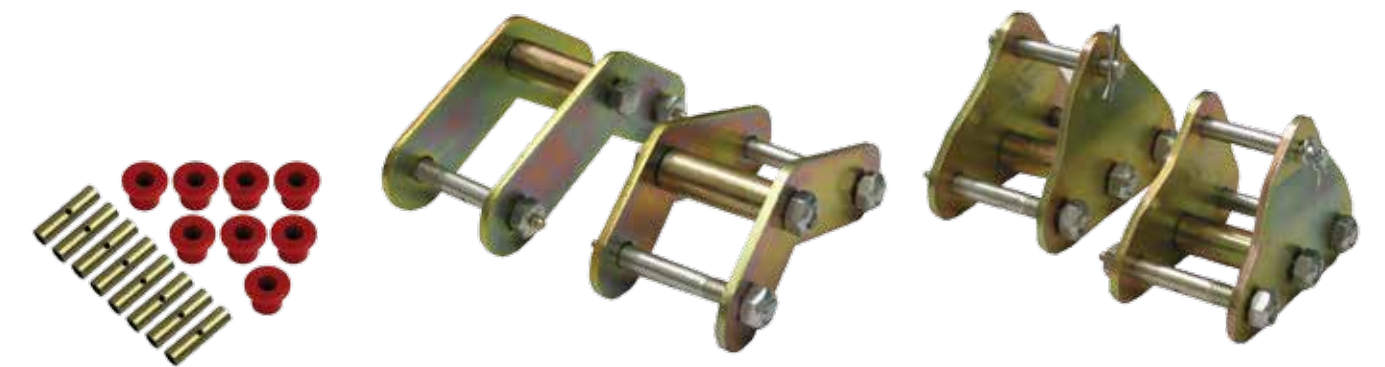

SH2545R

SH2545F

CJ

2" & 4" Systems for the '76-'86 Jeep CJ Many CJ owners will say the CJ is the only Jeep. Well Skyjacker® has designed the BEST rated springs for these true believers. These Softride® first-rate systems are the perfect way to transform your daily driver into the Conquering Jeep (CJ) you need it to be.



Jeep CJ5, CJ7, CJ8 1955-1986

Kit Ref #	Description	Qty	Part #	Front Shock	Rear Shock	Note
Jeep 1976-86 CJ 2.5" w/Hydro Shock Sport Series Leaf Springs - Suggested Tire Size - 31"						
J21BKH	Front Leaf Spring 2.5"	2	J20FSB	Incl.	Incl.	20
	Rear Leaf Spring 2.5"	2	J20RSB			
	Jeep CJ 1976-86 2.5" Component Box, includes (4) Hydro shocks	1	J21BH			
Jeep Wrangler 1976-86 CJ 2.5" Softride Series Leaf Springs - Suggested Tire Size - 31"						
J20K	Front Leaf Spring 2.5"	2	J20FS			20
	Rear Leaf Spring 2.5"	2	J20RS			
	Jeep Wrangler CJ 1976-86 Component Box	1	J24			
	Select a Shock Option F&R Shocks (2) each of desired Shock Series					
	Hydro Series Shock with Red Boot, White	2		H7012	H7023	
	Nitro Series Gas Shock with Red Boot, White	2		N8012	N8023	
	Black MAX Performance Shock with Black Boot, Black	2		B8512	B8523	
	M95 Monotube Performance Shock, Silver	2		M9512	M9523	
Jeep 1976-86 CJ 4.5" w/Hydro Shock Sport Series Leaf Springs - Suggested Tire Size - 33"						
J41BKH	Front Leaf Spring 4"	2	J40FSB	Incl.	Incl.	20
	Rear Leaf Spring 4"	2	J40RSB			
	Jeep CJ 1976-86 4" Component Box, includes (4) Hydro shocks	1	J41BH			
Jeep Wrangler 1976-86 CJ 4" Softride Series Leafs - Suggested Tire Size - 33"						
J40K	Front Leaf Spring 4"	2	J40FS			20
	Rear Leaf Spring 4"	2	J40RS			
	Jeep Wrangler CJ 1976-86 Component Box w/Hydro Shocks	1	J24			
	Select a Shock Option F&R Shocks (2) each of desired Shock Series					
	Hydro Series Shock with Red Boot, White	2		H7023	H7058	
	Nitro Series Gas Shock with Red Boot, White	2		N8023	N8058	
	Black MAX Performance Shock with Black Boot, Black	2		B8523	B8558	
	M95 Monotube Performance Shock, Silver	2		M9523	M9558	
Jeep Wrangler 1955-75 CJ 2.5" Softride Series Leaf Springs - Suggested Tire Size - 31"						
J32K	Front Leaf Spring 2.5"	2	J32FS			20
	Rear Leaf Spring 2.5"	2	J32RS			
	Jeep Wrangler CJ 1976-86 Component Box	1	J34			
	Select Shock Option F&R Shocks (2) each of desired Shock Series					
	Hydro Series Shock with Red Boot, White	2		H7023	H7023	
	Nitro Series Gas Shock with Red Boot, White	2		N8023	N8023	
	Black MAX Performance Shock with Black Boot, Black	2		B8523	B8523	
	M95 Monotube Performance Shock, Silver	2		M9523	M9523	

Notes 20) CJ8 Scrambler Models require fitted leaf, see page 222

Additional Jeep applications available. See pages 160-175.

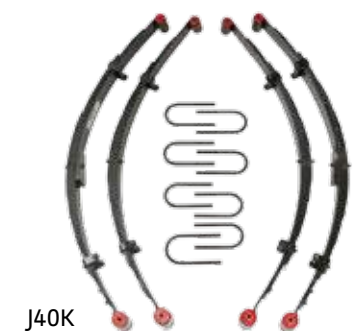
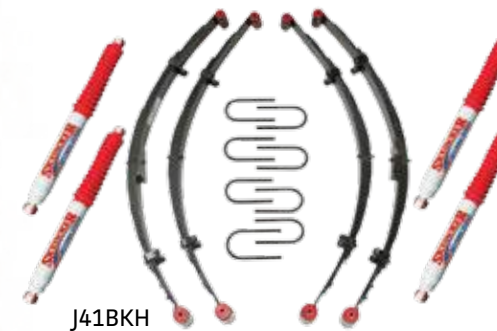



Jeep CJ5, CJ7, CJ8 1955-1986

Kit Ref #	Description	Qty	Part #	Front Shock	Rear Shock	Note
Jeep Wrangler 1955-75 CJ 4" Softride Series Leaf Springs - Suggested Tire Size - 33"						
J34K	Front Leaf Spring 4"	2	J34FS			
	Rear Leaf Spring 4"	2	J34RS			
	Jeep Wrangler CJ 1976-86 Component Box w/Hydro Shocks	1	J34			
	Select Shock Option F&R Shocks (2) each of desired Shock Series					
	Hydro Series Shock with Red Boot, White	2		H7058	H7058	
	Nitro Series Gas Shock with Red Boot, White	2		N8058	N8058	
	Black MAX Performance Shock with Black Boot, Black	2		B8558	B8558	
	M95 Monotube Performance Shock, Silver	2		M9558	M9558	
Notes	20) CJ8 Scrambler Models require fitted leaf, see page 222					

Options Jeep Wrangler CJ 1955-86

Jeep CJ Options	Description	Qty	Part #	Front Shock	Rear Shock	Note
	Drop Pitman Arm 4" lift Power Steering 1976-86	1	JA250			
	Drop Pitman Arm 4" lift Manual Steering 1976-86	1	JA150			
	Drop Pitman Arm 4" lift Power Steering 1972-75	1	JA550			
	Drop Pitman Arm 4" lift Manual Steering 1972-75	1	JA650			
	Drop Pitman Arm 2" lift Power Steering 1972-75	1	JA552			
	Drop Pitman Arm 2" lift Manual Steering 1972-75	1	JA652			
	Dual Steering Stabilizer White w/Red Boot	1	7200			
	Dual Steering Stabilizer Silver w/Black Boot	1	9200			
	Front & Rear Complete Frame Shackle Bushings Wrangler CJ 1976-86	1	SE4CJ			
	1" Body Lift Complete all parts replacement set 1980-86 CJ5 & CJ7	1	SS951P			
	1" Body Lift Complete all parts replacement set 1976-79 CJ5 & CJ7	1	SS961P			

Additional Jeep applications available. See pages 160-175.

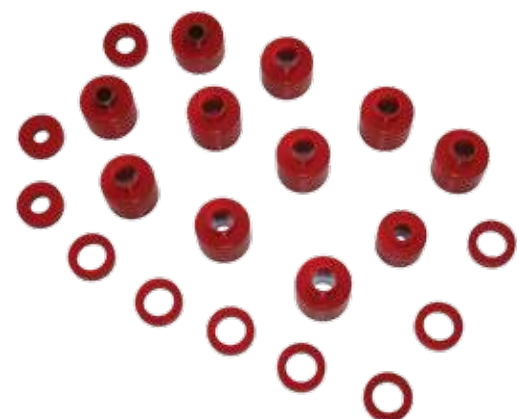

SS961P



JA250



TCL35



TCL151

Jeep Grand Cherokee 1993-2010

Kit Ref #	Description	Qty	Part #	Front Shock	Rear Shock	Note
Jeep Grand Cherokee WK 2005-10 2" Poly Spacer - Suggested Tire Size - 30"-30.5"						
WK20	Component Box Jeep Grand Cherokee WK 2005-10 2" Poly Spacers F&R	1	WJ20			
	Select Shock Option F&R Shocks (2) each of desired Series					
	Hydro Series Shock with Red Boot, White	2			H7088	
	Nitro Series Gas Shock with Red Boot, White	2			N8088	
	Black MAX Performance Shock with Black Boot, Black	2			B8588	
	M95 Monotube Performance Shock, Silver	2			M9558	
Jeep Grand Cherokee WJ 1999-2004 2" Poly Spacer - Suggested Tire Size - 31"						
WJ20	Component Box Jeep Grand Cherokee WJ 1999-2004 2" Poly Spacers F&R	1	WJ20			
	Select Shock Option F&R Shocks (2) each of desired Shock Series					
	Hydro Series Shock with Red Boot, White	2		H7016	H7044	
	Nitro Series Gas Shock with Red Boot, White	2		N8016	N8044	
	Black MAX Performance Shock with Black Boot, Black	2		B8516	B8544	
	M95 Monotube Performance Shock, Silver	2		M9516	M9544	
Jeep Grand Cherokee ZJ 1993-98 2" Poly Spacer - Suggested Tire Size - 31"						
ZJ20	Component Box 1993-98 Jeep Grand Cherokee ZJ 2" Poly Spacers front & rear	1	ZJ20			
	Select Shock Option F&R Shocks (2) each of desired Shock Series					
	Hydro Series Shock with Red Boot, White	2		H7016	H7023	
	Nitro Series Gas Shock with Red Boot, White	2		N8016	N8023	
	Black MAX Performance Shock with Black Boot, Black	2		B8516	B8523	
	M95 Monotube Performance Shock, Silver	2		M9516	M9523	
Jeep Grand Cherokee ZJ 1993-98 3" Kit - Suggested Tire Size - 31"						
GC301K	Front Coil Springs Jeep	1	JC30F			
	Rear Coil Springs 1993-98 Jeep Grand Cherokee ZJ	1	GC20R			
	Component Box 1993-98 Jeep Grand Cherokee ZJ	1	GC30			
	Select Shock Option F&R Shocks (2) each of desired Shock Series					
	Hydro Series Shock with Red Boot, White	2		H7016	H7023	
	Nitro Series Gas Shock with Red Boot, White	2		N8016	N8023	
	Black MAX Performance Shock with Black Boot, Black	2		B8516	B8523	
	M95 Monotube Performance Shock, Silver	2		M9516	M9523	



ZJ20



GC301K



WJ20

Jeep Liberty 2002-2012

Kit Ref #	Description	Qty	Part #	Front Shock	Rear Shock	Note
Jeep Liberty KK 2008-12 2" Poly Spacer - Suggested Tire Size - 30"-30.5"						
KKN25	Jeep Liberty KK 2008-12 2" Poly Spacer front & rear	1	KKN25			
	Select Shock Option F&R Shocks (2) each of desired Shock Series					
	Hydro Series Shock with Red Boot, White	2			H7088	
	Nitro Series Gas Shock with Red Boot, White	2			N8088	
	Black MAX Performance Shock with Black Boot, Black	2			B8588	
	M95 Monotube Performance Shock, Silver	2			M9558	
Jeep Liberty KK 2008-12 2" 2.5-3" - Suggested Tire Size - 30"-30.5"						
LIB258K	Component Box Jeep Liberty KK 2008-12 2.5-3" Coils Spring Front & Rear	1	LIB250			
	Jeep Liberty KK 2008-12 2.5-3" Rear Coils Springs	1	LIB208R			
	Select Shock Option F&R Shocks (2) each of desired Shock Series					
	Hydro Series Shock with Red Boot, White	2			H7088	
	Nitro Series Gas Shock with Red Boot, White	2			N8088	
	Black MAX Performance Shock with Black Boot, Black	2			B8588	
	M95 Monotube Performance Shock, Silver	2			M9558	
Jeep Liberty KJ 2002-07 2" Poly Spacer - Suggested Tire Size - 30"-30.5"						
KJ25	Jeep Liberty KJ 2002-07 2" Poly Spacer Front & Rear	1	KJ25			
	Select Shock Option F&R Shocks (2) each of desired Shock Series					
	Hydro Series Shock with Red Boot, White	2			H7088	
	Nitro Series Gas Shock with Red Boot, White	2			N8088	
	Black MAX Performance Shock with Black Boot, Black	2			B8588	
	M95 Monotube Performance Shock, Silver	2			M9558	
Jeep Liberty KJ 2002-07 2" 2.5-3" - Suggested Tire Size - 30"-30.5"						
LIB250K	Component Box Jeep Liberty KJ 2002-07 2.5-3" Coils Spring Front & Rear	1	LIB250			
	Jeep Liberty KJ 2008-12 2.5-3" Rear Coils Springs	1	LIB25R			
	Select Shock Option F&R Shocks (2) each of desired Shock Series					
	Hydro Series Shock with Red Boot, White	2			H7088	
	Nitro Series Gas Shock with Red Boot, White	2			N8088	
	Black MAX Performance Shock with Black Boot, Black	2			B8588	
	M95 Monotube Performance Shock, Silver	2			M9558	
Notes	22) LS16K Skyjacker Limiting Strap Recommended					
Additional Jeep applications available. See pages 160-175.						



Kit Ref #	Description	Qty	Part #	Front Shock	Rear Shock	Note
Cherokee, Wagoneer Full Size 1984-1991 4" Front Leaf Springs Rear Block - Suggested Tire Size - 35"						
JP45K	Jeep Wagoneer Full Size 1984-1991 rear blocks & ubolts	1	JP45			
	Jeep Wagoneer Front Leaf Spring Full Size 1984-1991 4"	2	JP40FS			
	Jeep Wagoneer Full Size Pitman Arm Required	1	JA350			23
	Select Shock Option F&R Shocks (2) each of desired Shock Series					
	Hydro Series Shock with Red Boot, White	2		H7088	H7088	
	Nitro Series Gas Shock with Red Boot, White	2		N8088	N8088	
	Black MAX Performance Shock with Black Boot, Black	2		B8588	B8588	
	M95 Monotube Performance Shock, Silver	2		M9558	M9558	
Cherokee, Wagoneer Full Size 1984-1991 4" Front & Rear Leaf Springs - Suggested Tire Size - 35"						
JP45KS	Jeep Wagoneer Full Size 1984-1991 4"	1	JP45S			
	Jeep Wagoneer Front Leaf Spring Full Size 1984-1991 4"	2	JP40FS			
	Jeep Wagoneer Rear Leaf Spring Full Size 1984-1991 4"	2	JP40RS			
	Jeep Wagoneer Full Size Pitman Arm Required	1	JA350			23
	Select Shock Option F&R Shocks (2) each of desired Shock Series					
	Hydro Series Shock with Red Boot, White	2		H7088	H7088	
	Nitro Series Gas Shock with Red Boot, White	2		N8088	N8088	
	Black MAX Performance Shock with Black Boot, Black	2		B8588	B8588	
	M95 Monotube Performance Shock, Silver	2		M9558	M9558	
J10, J20, Cherokee, Wagoneer Full Size 1974-83 4" Front Leaf Springs Rear Block - Suggested Tire Size - 35"						
JP40K	Jeep Wagoneer Full Size 1974-83 rear blocks & ubolts	1	JP40			
	Jeep Wagoneer Front Leaf Spring Full Size 4"	2	JP40FS			
	Jeep Wagoneer Full Size Pitman Arm Required	1	JA350			23
	Select Shock Option F&R Shocks (2) each of desired Shock Series					
	Hydro Series Shock with Red Boot, White	2		H7088	H7088	
	Nitro Series Gas Shock with Red Boot, White	2		N8088	N8088	
	Black MAX Performance Shock with Black Boot, Black	2		B8588	B8588	
	M95 Monotube Performance Shock, Silver	2		M9558	M9558	
J10, J20, Cherokee, Wagoneer Full Size 1974-83 4" Front & Rear Leafs - Suggested Tire Size - 35"						
JP40KS	Jeep Wagoneer Full Size 1974-83 4"	1	JP40S			
	Jeep Wagoneer Front Leaf Spring Full Size 4"	2	JP40FS			
	Jeep Wagoneer Rear Leaf Spring Full Size 4"	2	JP40RS			
	Jeep Wagoneer Full Size Pitman Arm Required	1	JA350			23
	Select Shock Option F&R Shocks (2) each of desired Shock Series					
	Hydro Series Shock with Red Boot, White	2		H7088	H7088	
	Nitro Series Gas Shock with Red Boot, White	2		N8088	N8088	
	Black MAX Performance Shock with Black Boot, Black	2		B8588	B8588	
	M95 Monotube Performance Shock, Silver	2		M9558	M9558	
Notes	23) Works with Power Steering Models Only					



LIFT	Quick Kit Reference	KIT NOTES	Component Box (Requires 1 of Each)	Front Springs		Rear Springs		Add-A-Leafs	Steering Correction (Order 1 Each)	Steering Stabilizers						HYDRO Shocks		NITRO Shocks		BLACK MAX		M95 Shocks		Labor Hours			
				Qty	Part #	Qty	Part #			White			Black			Silver			White		Black		Silver				
										OEM	Single	Dual	OEM	Single	Dual	OEM	Single	Dual	Front	Rear	Front	Rear	Front		Rear	Front	Rear
07-16 WRANGLER JK / RUBICON 2 & 4 DOOR 2WD / 4WD																											
LOWERING COILS																											
NOTE: ALL SHOCKS MUST BE ORDERED SEPARATELY																											
07-16 Wrangler JK / Rubicon 2 & 4 Door 4WD Includes Front & Rear Lowering Coil Springs																											
(2)-(2.5)	LOWJK024		LOWJK024	1	Included	1	Included			7003		7203 ^(B)	8003		8203 ^(B)	9003		9203 ^(B)	---	---	N8005	N8007	---	---	---	---	6
KIT NOTES: These Coil Springs will Lower the Vehicle's Center of Gravity 2-2.5". (B). Boot Not Included Due to Clearance Issues.																											
POLYURETHANE VALUE KIT																											
07-16 Wrangler JK / Rubicon 2 & 4 Door 2WD / 4WD Polyurethane Front Spacers																											
3/4"	JKFPS75		JKFPS75							7003		7203 ^(B)	8003		8203 ^(B)	9003		9203 ^(B)	H7001	---	N8001	---	B8501	---	M9501	---	2
07-16 Wrangler JK / Rubicon 2 & 4 Door 2WD / 4WD Polyurethane Rear Spacers																											
3/4"	JKRPS75		JKRPS75							7003		7203 ^(B)	8003		8203 ^(B)	9003		9203 ^(B)	---	H7007	---	N8007	---	B8507	---	M9507	2
07-16 Wrangler JK / Rubicon 2 & 4 Door 2WD / 4WD 2" Front & 2" Rear Kit - Polyurethane Spacers																											
2"	JK20		JK20							7003		7203 ^(B)	8003		8203 ^(B)	9003		9203 ^(B)	H7035	H7037	N8035	N8037	B8535	B8537	M9535	M9537	5
07-16 Wrangler JK / Rubicon 2 & 4 Door 2WD / 4WD 2" Front & 2" Rear Leveling Kit - Polyurethane Spacers																											
2"	JK23		JK23							7003		7203 ^(B)	8003		8203 ^(B)	9003		9203 ^(B)	H7035	H7037	N8035	N8037	B8535	B8537	M9535	M9537	5
07-16 WRANGLER JK / RUBICON 4 DOOR 2WD / 4WD																											
STANDARD SERIES 4 DOOR SOFTRIDE®																											
NOTE: ALL SHOCKS MUST BE ORDERED SEPARATELY																											
07-16 Wrangler JK / Rubicon 4 Door Only 2WD / 4WD Includes Front & Rear Softride® Coil Springs																											
2.5"	JK25BPHSR		JK25BPHSR	1	Included	1	Included			7003		7203 ^(B)	8003		8203 ^(B)	9003		9203 ^(B)	Included	Included	---	---	---	---	---	---	5
KIT NOTES: Softride®, No Lower Control Arms, Includes (4) Hydro Shocks. Control Arm & Brake Line Upgrades are Available. See JK options. (B). Boot Not Included Due to Clearance Issues.																											
2.5"	JK25BPNSR		JK25BPNSR	1	Included	1	Included			7003		7203 ^(B)	8003		8203 ^(B)	9003		9203 ^(B)	---	---	Included	Included	---	---	---	---	5
KIT NOTES: Softride®, No Lower Control Arms, Includes (4) Nitro Shocks. Control Arm & Brake Line Upgrades are Available. See JK options. (B). Boot Not Included Due to Clearance Issues.																											
2.5"	JK25BPBSR		JK25BPBSR	1	Included	1	Included			7003		7203 ^(B)	8003		8203 ^(B)	9003		9203 ^(B)	---	---	---	---	Included	Included	---	---	5
KIT NOTES: Softride®, No Lower Control Arms, Includes (4) Black MAX Shocks. Control Arm & Brake Line Upgrades are Available. See JK options. (B). Boot Not Included Due to Clearance Issues.																											
2.5"	JK2500BPMSR		JK2500BPMSR	1	Included	1	Included			7003		7203 ^(B)	8003		8203 ^(B)	9003		9203 ^(B)	---	---	---	---	---	---	Included	Included	5
KIT NOTES: Softride®, No Lower Control Arms, Includes (4) M95 Shocks. Control Arm & Brake Line Upgrades are Available. See JK options. (B). Boot Not Included Due to Clearance Issues.																											
4"	JK40BPHSR		JK40BPHSR	1	Included	1	Included		JA770	7003		7203 ^(B)	8003		8203 ^(B)	9003		9203 ^(B)	Included	Included	---	---	---	---	---	---	5
KIT NOTES: Softride®, No Lower Control Arms, Includes (4) Hydro Shocks. Adjustable Front Track Bar, Control Arm, & Brake Line Upgrades are Available. See JK options. (B). Boot Not Included Due to Clearance Issues.																											
4"	JK40BPNSR		JK40BPNSR	1	Included	1	Included		JA770	7003		7203 ^(B)	8003		8203 ^(B)	9003		9203 ^(B)	---	---	Included	Included	---	---	---	---	5
KIT NOTES: Softride®, No Lower Control Arms, Includes (4) Nitro Shocks. Adjustable Front Track Bar, Control Arm, & Brake Line Upgrades are Available. See JK options. (B). Boot Not Included Due to Clearance Issues.																											
4"	JK40BPBSR		JK40BPBSR	1	Included	1	Included		JA770	7003		7203 ^(B)	8003		8203 ^(B)	9003		9203 ^(B)	---	---	---	---	Included	Included	---	---	5
KIT NOTES: Softride®, No Lower Control Arms, Includes (4) Black MAX Shocks. Adjustable Front Track Bar, Control Arm, & Brake Line Upgrades are Available. See JK options. (B). Boot Not Included Due to Clearance Issues.																											
4"	JK400PMSR		JK400PMSR	1	Included	1	Included		JA770	7003		7203 ^(B)	8003		8203 ^(B)	9003		9203 ^(B)	---	---	---	---	---	---	Included	Included	5
KIT NOTES: Softride®, No Lower Control Arms, Includes (4) M95 Shocks. Adjustable Front Track Bar, Control Arm, & Brake Line Upgrades are Available. See JK options. (B). Boot Not Included Due to Clearance Issues.																											
FLEX SERIES 4 DOOR SOFTRIDE®																											
07-16 Wrangler JK / Rubicon 4 Door Only 2WD / 4WD Includes Front & Rear Softride® Coil Springs																											
2.5"	JK25BPHSRX		JK25BPHSR+JK24LLX	1	Included	1	Included			7003		7203 ^(B)	8003		8203 ^(B)	9003		9203 ^(B)	Included	Included	---	---	---	---	---	---	5
KIT NOTES: Softride®, No Lower Control Arms, Includes (4) Hydro Shocks. Upper Control Arm & Brake Line Upgrades are Available. See JK options. (B). Boot Not Included Due to Clearance Issues.																											
2.5"	JK25BPNSRX		JK25BPNSR+JK24LLX	1	Included	1	Included			7003		7203 ^(B)	8003		8203 ^(B)	9003		9203 ^(B)	---	---	Included	Included	---	---	---	---	5
KIT NOTES: Softride®, No Lower Control Arms, Includes (4) Nitro Shocks. Upper Control Arm & Brake Line Upgrades are Available. See JK options. (B). Boot Not Included Due to Clearance Issues.																											
2.5"	JK25BPBSRX		JK25BPBSR+JK24LLX	1	Included	1	Included			7003		7203 ^(B)	8003		8203 ^(B)	9003		9203 ^(B)	---	---	---	---	Included	Included	---	---	5
KIT NOTES: Softride®, No Lower Control Arms, Includes (4) Black MAX Shocks. Upper Control Arm & Brake Line Upgrades are Available. See JK options. (B). Boot Not Included Due to Clearance Issues.																											
2.5"	JK2500BPMSRX		JK2500BPMSR+JK24LLX	1	Included	1	Included			7003		7203 ^(B)	8003		8203 ^(B)	9003		9203 ^(B)	---	---	---	---	---	---	Included	Included	5
KIT NOTES: Softride®, No Lower Control Arms, Includes (4) M95 Shocks. Upper Control Arm & Brake Line Upgrades are Available. See JK options. (B). Boot Not Included Due to Clearance Issues.																											
4"	JK40BPHSRX		JK40BPHSR+JK24LLX	1	Included	1	Included		JA770	7003		7203 ^(B)	8003		8203 ^(B)	9003		9203 ^(B)	Included	Included	---	---	---	---	---	---	5
KIT NOTES: Softride®, No Lower Control Arms, Includes (4) Hydro Shocks. Adjustable Front Track Bar, Upper Control Arm, & Brake Line Upgrades are Available. See JK options. (B). Boot Not Included Due to Clearance Issues.																											
4"	JK40BPNSRX		JK40BPNSR+JK24LLX	1	Included	1	Included		JA770	7003		7203 ^(B)	8003		8203 ^(B)	9003		9203 ^(B)	---	---	Included	Included	---	---	---	---	5
KIT NOTES: Softride®, No Lower Control Arms, Includes (4) Nitro Shocks. Adjustable Front Track Bar, Upper Control Arm, & Brake Line Upgrades are Available. See JK options. (B). Boot Not Included Due to Clearance Issues.																											
4"	JK40BPBSRX		JK40BPBSR+JK24LLX	1	Included	1	Included		JA770	7003		7203 ^(B)	8003		8203 ^(B)	9003		9203 ^(B)	---	---	---	---	Included	Included	---	---	5
KIT NOTES: Softride®, No Lower Control Arms, Includes (4) Black MAX Shocks. Adjustable Front Track Bar, Upper Control Arm, & Brake Line Upgrades are Available. See JK options. (B). Boot Not Included Due to Clearance Issues.																											
4"	JK400PMSRX		JK400BPMSR+JK24LLX	1	Included	1	Included		JA770	7003		7203 ^(B)	8003		8203 ^(B)	9003		9203 ^(B)	---	---	---	---	---	---	Included	Included	5
KIT NOTES: Softride®, No Lower Control Arms, Includes (4) M95 Shocks. Adjustable Front Track Bar, Upper Control Arm, & Brake Line Upgrades are Available. See JK options. (B). Boot Not Included Due to Clearance Issues.																											

LIFT	Quick Kit Reference	KIT NOTES	Component Box (Requires 1 of Each)	Front Springs		Rear Springs		Add-A-Leafs	Steering Correction (Order 1 Each)	Steering Stabilizers						HYDRO Shocks		NITRO Shocks		BLACK MAX		M95 Shocks		Labor Hours		
				Qty	Part #	Qty	Part #			White			Black			Silver			White		Black		Silver			
										OEM	Single	Dual	OEM	Single	Dual	OEM	Single	Dual	Front	Rear	Front	Rear	Front		Rear	Front
07-16 WRANGLER JK / RUBICON 2 DOOR 2WD / 4WD																										
STANDARD SERIES 2 DOOR SOFTRIDE®																										
07-16 Wrangler JK / Rubicon 2 Door Only 2WD / 4WD Includes Front & Rear Softride® Coil Springs																										
2.5"	JK200BPHSR		JK200BPHSR	1	Included	1	Included			7003	7203 ^(B)	8003	8203 ^(B)	9003	9203 ^(B)	Included	Included	---	---	---	---	---	---	---	5	
KIT NOTES: Softride®, No Lower Control Arms, Includes (4) Hydro Shocks. Control Arm & Brake Line Upgrades are Available. See JK options. (B). Boot Not Included Due to Clearance Issues.																										
2.5"	JK200BPNSR		JK200BPNSR	1	Included	1	Included			7003	7203 ^(B)	8003	8203 ^(B)	9003	9203 ^(B)	---	---	---	---	---	---	---	---	---	5	
KIT NOTES: Softride®, No Lower Control Arms, Includes (4) Nitro Shocks. Control Arm & Brake Line Upgrades are Available. See JK options. (B). Boot Not Included Due to Clearance Issues.																										
2.5"	JK200BPBSR		JK200BPBSR	1	Included	1	Included			7003	7203 ^(B)	8003	8203 ^(B)	9003	9203 ^(B)	---	---	---	---	---	---	---	---	---	5	
KIT NOTES: Softride®, No Lower Control Arms, Includes (4) Black MAX Shocks. Control Arm & Brake Line Upgrades are Available. See JK options. (B). Boot Not Included Due to Clearance Issues.																										
2.5"	JK200BPMSR		JK200BPMSR	1	Included	1	Included			7003	7203 ^(B)	8003	8203 ^(B)	9003	9203 ^(B)	---	---	---	---	---	---	---	---	Included	Included	5
KIT NOTES: Softride®, No Lower Control Arms, Includes (4) M95 Shocks. Control Arm & Brake Line Upgrades are Available. See JK options. (B). Boot Not Included Due to Clearance Issues.																										
3.5"	JK350BPHSR		JK350BPHSR	1	Included	1	Included		JA770	7003	7203 ^(B)	8003	8203 ^(B)	9003	9203 ^(B)	Included	Included	---	---	---	---	---	---	---	5	
KIT NOTES: Softride®, No Lower Control Arms, Includes (4) Hydro Shocks. Adjustable Front Track Bar, Control Arm, & Brake Line Upgrades are Available. See JK options. (B). Boot Not Included Due to Clearance Issues.																										
3.5"	JK350BPNSR		JK350BPNSR	1	Included	1	Included		JA770	7003	7203 ^(B)	8003	8203 ^(B)	9003	9203 ^(B)	---	---	---	---	---	---	---	---	---	5	
KIT NOTES: Softride®, No Lower Control Arms, Includes (4) Nitro Shocks. Adjustable Front Track Bar, Control Arm, & Brake Line Upgrades are Available. See JK options. (B). Boot Not Included Due to Clearance Issues.																										
3.5"	JK350BPBSR		JK350BPBSR	1	Included	1	Included		JA770	7003	7203 ^(B)	8003	8203 ^(B)	9003	9203 ^(B)	---	---	---	---	---	---	---	---	Included	Included	5
KIT NOTES: Softride®, No Lower Control Arms, Includes (4) Black MAX Shocks. Adjustable Front Track Bar, Control Arm, & Brake Line Upgrades are Available. See JK options. (B). Boot Not Included Due to Clearance Issues.																										
3.5"	JK350BPMSR		JK350BPMSR	1	Included	1	Included		JA770	7003	7203 ^(B)	8003	8203 ^(B)	9003	9203 ^(B)	---	---	---	---	---	---	---	---	Included	Included	5
KIT NOTES: Softride®, No Lower Control Arms, Includes (4) M95 Shocks. Adjustable Front Track Bar, Control Arm, & Brake Line Upgrades are Available. See JK options. (B). Boot Not Included Due to Clearance Issues.																										
07-16 WRANGLER JK / RUBICON 2 DOOR 2WD / 4WD																										
FLEX SERIES 2 DOOR SOFTRIDE®																										
07-16 Wrangler JK / Rubicon 2 Door Only 2WD / 4WD Includes Front & Rear Softride® Coil Springs																										
2.5"	JK200BPHSRX		JK200BPHSR+JK24LLX	1	Included	1	Included			7003	7203 ^(B)	8003	8203 ^(B)	9003	9203 ^(B)	Included	Included	---	---	---	---	---	---	---	5	
KIT NOTES: Softride®, No Lower Control Arms, Includes (4) Hydro Shocks. Upper Control Arm & Brake Line Upgrades are Available. See JK options. (B). Boot Not Included Due to Clearance Issues.																										
2.5"	JK200BPNSRX		JK200BPNSR+JK24LLX	1	Included	1	Included			7003	7203 ^(B)	8003	8203 ^(B)	9003	9203 ^(B)	---	---	---	---	---	---	---	---	---	5	
KIT NOTES: Softride®, No Lower Control Arms, Includes (4) Nitro Shocks. Upper Control Arm & Brake Line Upgrades are Available. See JK options. (B). Boot Not Included Due to Clearance Issues.																										
2.5"	JK200BPBSRX		JK200BPBSR+JK24LLX	1	Included	1	Included			7003	7203 ^(B)	8003	8203 ^(B)	9003	9203 ^(B)	---	---	---	---	---	---	---	---	Included	Included	5
KIT NOTES: Softride®, No Lower Control Arms, Includes (4) Black MAX Shocks. Upper Control Arm & Brake Line Upgrades are Available. See JK options. (B). Boot Not Included Due to Clearance Issues.																										
2.5"	JK200BPMSRX		JK200BPMSR+JK24LLX	1	Included	1	Included			7003	7203 ^(B)	8003	8203 ^(B)	9003	9203 ^(B)	---	---	---	---	---	---	---	---	Included	Included	5
KIT NOTES: Softride®, No Lower Control Arms, Includes (4) M95 Shocks. Upper Control Arm & Brake Line Upgrades are Available. See JK options. (B). Boot Not Included Due to Clearance Issues.																										
3.5"	JK350BPHSRX		JK350BPHSR+JK24LLX	1	Included	1	Included		JA770	7003	7203 ^(B)	8003	8203 ^(B)	9003	9203 ^(B)	Included	Included	---	---	---	---	---	---	---	5	
KIT NOTES: Softride®, No Lower Control Arms, Includes (4) Hydro Shocks. Adjustable Front Track Bar, Upper Control Arm, & Brake Line Upgrades are Available. See JK options. (B). Boot Not Included Due to Clearance Issues.																										
3.5"	JK350BPNSRX		JK350BPNSR+JK24LLX	1	Included	1	Included		JA770	7003	7203 ^(B)	8003	8203 ^(B)	9003	9203 ^(B)	---	---	---	---	---	---	---	---	---	5	
KIT NOTES: Softride®, No Lower Control Arms, Includes (4) Nitro Shocks. Adjustable Front Track Bar, Upper Control Arm, & Brake Line Upgrades are Available. See JK options. (B). Boot Not Included Due to Clearance Issues.																										
3.5"	JK350BPBSRX		JK350BPBSR+JK24LLX	1	Included	1	Included		JA770	7003	7203 ^(B)	8003	8203 ^(B)	9003	9203 ^(B)	---	---	---	---	---	---	---	---	Included	Included	5
KIT NOTES: Softride®, No Lower Control Arms, Includes (4) Black MAX Shocks. Adjustable Front Track Bar, Upper Control Arm, & Brake Line Upgrades are Available. See JK options. (B). Boot Not Included Due to Clearance Issues.																										
3.5"	JK350BPMSRX		JK350BPMSR+JK24LLX	1	Included	1	Included		JA770	7003	7203 ^(B)	8003	8203 ^(B)	9003	9203 ^(B)	---	---	---	---	---	---	---	---	Included	Included	5
KIT NOTES: Softride®, No Lower Control Arms, Includes (4) M95 Shocks. Adjustable Front Track Bar, Upper Control Arm, & Brake Line Upgrades are Available. See JK options. (B). Boot Not Included Due to Clearance Issues.																										
LONG ARM SERIES - WITH UPPER & LOWER LINKS																										
07-16 Wrangler JK / Rubicon 2 & 4 Door 2WD / 4WD Includes Front & Rear Coil Springs																										
4-5"	JK40LAK-SX	E24, E26, E27	JK46LA-SX + JK40LA	1	JK40F	1	JK40R		JA770	7003	7203 ^(B)	8003	8203 ^(B)	9003	9203 ^(B)	H7065	H7067	N8065	N8067	B8565	N8067	B8565	M9567	10		
6-7"	JK60LAK-SX	E24, E26, E27	JK46LA-SX + JK60LA	1	JK60F	1	JK60R		JA770	7003	7203 ^(B)	8003	8203 ^(B)	9003	9203 ^(B)	H7075	H7087	N8075	N8087	B8575	N8087	B8575	M9587	10		
KIT NOTES: Factory Skid Plates Can Not be Re-Used with Long Arm Series. E24. Due to Weight Differences 2 Door Models may Receive an Additional 1" of Lift Over 4 Door Models with the 6-7" Kit - New Front & Rear Drive Shaft is Required. OEM Wheel can be Used. E26. 2 Door Models will Require Rear CV Driveshaft. Part # CAM700 Highly Recommended for 2 Door Models for Optimum Pinion Adjustment. E27. For 12-16 Models - 3.5" Lifts & Up will Require Exhaust Spacers Part # JK36ESK. (B). Boot Not Included Due to Clearance Issues.																										
07-16 WRANGLER JK / RUBICON 2 & 4 DOOR 4WD																										
LeDuc Series Coil-Over Kits																										
07-16 Wrangler JK / Rubicon 2 & 4 Door 4WD																										
				Front Coil-Overs		Rear Coil-Overs																				
3.54.5"	JK42LSK-SX	E26, E28, E29	JK46LA-SX + JK40LA + JK62FLSB + JK42RLSB	1	JK62FLS	1	JK62RLS		JA770	7003	7203 ^(B)	8003	8203 ^(B)	9003	9203 ^(B)	---	---	---	---	---	---	---	---	---	12	
5-6"	JK62LSK-SX	E26, E28, E29	JK46LA-SX + JK60LA + JK62FLSB + JK62RLSB	1	JK62FLS	1	JK62RLS		JA770	7003	7203 ^(B)	8003	8203 ^(B)	9003	9203 ^(B)	---	---	---	---	---	---	---	---	---	12	
KIT NOTES: Factory Skid Plates Can Not be Re-Used with Long Arm Series. E26. 2 Door Models will Require Rear CV Driveshaft. E28. Driveshaft Modifications required. Maximum 4.5" backspacing is required. E29. Optional air bump stop kit available. Part# JKLSAB. (B). Boot Not Included Due to Clearance Issues.																										

LIFT	Quick Kit Reference	KIT NOTES	Component Box (Requires 1 of Each)	Front Springs		Rear Springs		Add-A-Leafs	Steering Correction (Order 1 Each)	Steering Stabilizers						HYDRO Shocks		NITRO Shocks		BLACK MAX		M95 Shocks		Labor Hours
				Qty	Part #	Qty	Part #			White		Black		Silver		White		White		Black		Silver		
										OEM	Single	Dual	OEM	Single	Dual	OEM	Single	Dual	Front	Rear	Front	Rear	Front	

07-16 WRANGLER JK / RUBICON 2 & 4 DOOR 4WD **NOTE: ALL SHOCKS MUST BE ORDERED SEPARATELY**

Part #	Description	Lift	Part #	Description	Lift
JKFPS75	.75" Front Coil Spring Isolator Pads - Pair		CAM700	Front Lower / Rear Upper Cam Bolt Kit	
JKRPS75	.75" Rear Coil Spring Isolator Pads - Pair		JK2717B	Dual Load Balljoint Kit - NEW	
JK20PSF	2" Front Coil Spring Isolator Pads - Pair		JK717DL	Rock Ready® Heavy Duty Drag Link - NEW	
JK20PSR	2" Rear Coil Spring Isolator Pads - Pair		JK717TR	Rock Ready® Heavy Duty Tie Rod - NEW	
JKLL24F	Front Lower Links - Pair	2-4"	JK717RC	Replacement Cartridge for Tie Rod / Drag Link - NEW	
JKLL24R	Standard Rear Lower Links - Pair	2-4"	JKFBL60	Stainless Steel Front Brake Line Set for 4-7" Lift	
JKLL24F-SX	Single Flex Front Lower Links with Currie Johnny Joints - Pair - NEW	2-5"	JKRBL60	Stainless Steel Rear Brake Line Set for 4-7" Lift	
JKLL24R-SX	Single Flex Rear Lower Links with Currie Johnny Joints - Pair - NEW	2-5"	SBE126	Front Double Disconnect Swaybar Links	2-5"
JKULF26-SX	Single Flex Front Upper Links - Pair	2-7"	JKFTBA717	Front Adjustable Track Bar	
JKULR26-SX	Single Flex Rear Upper Links - Pair	2-7"	JKRTBA717	Rear Adjustable Track Bar	
JKLSAB	Air Bump Stop Kit	4-6"			

04-06 WRANGLER TJ UNLIMITED LJ / RUBICON UNLIMITED 4WD **NOTE: ALL SHOCKS MUST BE ORDERED SEPARATELY**

POLYURETHANE VALUE KIT

04-06 Wrangler TJ Unl. LJ / Rubicon Unl. 4WD		Polyurethane Spacers																									
2"	TJ20		TJ20							7009		7219	8009		8219	9009		9219	H7016	H7018	N8016	N8018	B8516	B8518	M9516	M9518	4

STANDARD SERIES

04-06 Wrangler TJ Unl. LJ / Rubicon Unl. 4WD **Includes Front & Rear Coil Springs**

2.5"	TJ253KU	E8, E12, E22	TJ253	1	TJ25F	1	TJ25R*			7009		7219	8009		8219	9009		9219	H7016	H7018	N8016	N8018	B8516	B8518	M9516	M9518	6
3"	TJ30BPH	E8, E12	TJ30BPH		Included		Included			7009		7219	8009		8219	9009		9219	Included	Included							
4"	TJ403KU	E8, E12, E22	TJ403	1	TJ40F	1	TJ40R*		Included (E10)	7009		7219	8009		8219	9009		9219	H7025	H7028	N8025	N8028	B8525	B8528	M9525	M9528	6
4"	TJ403BPH	E8, E10, E12, E22	TJ403BPH*		Included		Included		Included (E10)	7009		7219	8009		8219	9009		9219	Included	Included							6

KIT NOTES: * E8. Vehicles with 4 Cylinder Engines &/or Soft Tops will Sit a Little Higher Due to the Weight Difference. E10. # JA750 Included for Power Steering - Order # JA850 for Manual Steering. E12. See Page 219 for Brake Lines. E22. 6 Speed Models May Require Additional Modification. Contact Skyjacker® for more Information. * Part # SIP275 May be Required on Hard Top Models to Level the Rear.

VALUE FLEX SERIES - SHORT ARMS WITH LOWER LINKS ONLY

04-06 Wrangler TJ Unl. LJ / Rubicon Unl. 4WD **Includes Front & Rear Coil Springs (Includes NG Rebuildable Rod Ends)**

2.5"	TJ253KU-SVX	E8, E22, E12	TJ253-SVX	1	TJ25F	1	TJ25R*			7009		7219	8009		8219	9009		9219	H7016	H7018	N8016	N8018	B8516	B8518	M9516	M9518	8
4"	TJ403KU-SVX	E8, E22, E12	TJ403-SVX	1	TJ40F	1	TJ40R*		Included (E10)	7009		7219	8009		8219	9009		9219	H7025	H7028	N8025	N8028	B8525	B8528	M9525	M9528	8

KIT NOTES: * E8. Vehicles with 4 Cylinder Engines &/or Soft Tops will Sit a Little Higher Due to the Weight Difference. E12. See Page 219 for Brake Lines. E22. 6 Speed Models May Require Additional Modification. Contact Skyjacker® for more Information. * Part # SIP275 May be Required on Hard Top Models to Level the Rear.

ROCK READY® 1 SERIES - LONG ARMS WITH LOWER LINKS ONLY

04-06 Wrangler TJ Unl. LJ / Rubicon Unl. 4WD **Includes Front & Rear Coil Springs (Includes NG Rebuildable Rod Ends)**

6"	TJ60URR1K	E8, E14, E15, E16, E22	TJ60URRX+TJ60RR1	1	TJ60F	1	TJ60R*		Included (E10)	Included	7112				8112			9112		H7049	H7063	N8049	N8063	B8549	B8563	M9549	M9563	8
----	-----------	------------------------	------------------	---	-------	---	--------	--	----------------	----------	------	--	--	--	------	--	--	------	--	-------	-------	-------	-------	-------	-------	-------	-------	---

KIT NOTES: E8. Vehicles with 4 Cylinder Engines &/or Soft Tops will Sit a Little Higher Due to the Weight Difference. E14. 'Non Rubicons' REQUIRE Slip Yoke Eliminator Kit # RR231 & Replacement CV Driveshaft. Available Direct From Skyjacker®. Rubicons REQUIRE CV Yoke Part # CVR680 & Replacement CV Driveshaft. E15. Automatic Transmission Models must Remove Front Skid Plate for Driveshaft Clearance. E16. Modifications to the Factory Exhaust Cross-Over Pipe will be Necessary. E22. 6 Speed Models May Require Additional Modification. Contact Skyjacker® for more Information. * Part # SIP275 May be Required on Hard Top Models to Level the Rear.

03-06 WRANGLER TJ & RUBICON 4WD **NOTE: ALL SHOCKS MUST BE ORDERED SEPARATELY**

POLYURETHANE VALUE KIT

03-06 Wrangler TJ / Rubicon 4WD System		Polyurethane Spacers																									
2"	TJ20		TJ20							7009		7219	8009		8219	9009		9219	H7016	H7018	N8016	N8018	B8516	B8518	M9516	M9518	4

STANDARD SERIES - STANDARD LINKS

03-06 Wrangler TJ / Rubicon 4WD System **Includes Front & Rear Coil Springs**

2.5"	TJ250K		TJ250	1	TJ25F	1	TJ25R			7009		7219	8009		8219	9009		9219	H7016	H7018	N8016	N8018	B8516	B8518	M9516	M9518	6
2.5"	TJ25BPH	E8, E12	Included		Included		Included			7009		7219	8009		8219	9009		9219	Included	Included							6
3"	TJ30BPH	E8, E12	Included		Included		Included			7009		7219	8009		8219	9009		9219	Included	Included							
4"	TJ403BPH	E8, E10, E12, E22	TJ403BPH		Included		Included		Included (E10)	7009		7219	8009		8219	9009		9219	Included	Included							6

KIT NOTES: Kit # TJ250K Includes Rear Track Bar Bracket & Rear Cam Bolts. Optional Lower Control Arms Part # TJLL24. Optional Transfer Case Lowering Kit Part # TCL103. E8. Vehicles with 4 Cylinder Engines &/or Soft Tops will Sit a Little Higher Due to the Weight Difference. E10. # JA750 Included for Power Steering - Order # JA850 for Manual Steering. E12. See Page 219 for Brake Lines. E22. 6 Speed Models May Require Additional Modification. Contact Skyjacker® for more Information.

LIFT	Quick Kit Reference	KIT NOTES	Component Box (Requires 1 of Each)	Front Springs		Rear Springs		Add-A-Leafs	Steering Correction (Order 1 Each)	Steering Stabilizers						HYDRO Shocks		NITRO Shocks		BLACK MAX		M95 Shocks		Labor Hours			
				Qty	Part #	Qty	Part #			White		Black		Silver		White		Black		Silver							
4"	TJ403BPHX	E8, E10, E12, E22	TJ403BPHX	Included		Included			Included (E10)	OEM 7009	Single	Dual 7219	OEM 8009	Single	Dual 8219	OEM 9009	Single	Dual 9219	Front	Rear	Front	Rear	Front	Rear	Front	Rear	6

KIT NOTES: Kit # TJ403BPHX Includes Front & Rear Single Flex Lower Links, Rear Track Bar Bracket, Drop Pitman Arm, Transfer Case Lowering Kit, Front & Rear Extended End Links. E8. Vehicles with 4 Cylinder Engines &/or Soft Tops will Sit a Little Higher Due to the Weight Difference. E10. # JA750 Included for Power Steering - Order # JA850 for Manual Steering. E12. See Page 219 for Brake Lines. E22. 6 Speed Models May Require Additional Modification. Contact Skyjacker® for more Information.

4"	TJ4013PH	E8, E10, E12	Included	1	Included	1	Included		Included (E10)	7009		7219	8009		8219	9009		9219	Included	Included							6
----	----------	--------------	----------	---	----------	---	----------	--	----------------	------	--	------	------	--	------	------	--	------	----------	----------	--	--	--	--	--	--	---

KIT NOTES: Kit # TJ403BPHX Includes Front & Rear Single Flex Lower Links, Rear Track Bar Bracket, Drop Pitman Arm, Transfer Case Lowering Kit, Front & Rear Extended End Links. E8. Vehicles with 4 Cylinder Engines &/or Soft Tops will Sit a Little Higher Due to the Weight Difference. E10. # JA750 Included for Power Steering - Order # JA850 for Manual Steering. E12. See Page 219 for Brake Lines.

VALUE FLEX SERIES - SHORT ARMS WITH LOWER LINKS ONLY

03-06 Wrangler TJ / Rubicon 4WD System Includes Front & Rear Coil Springs (Includes NG Rebuildable Rod Ends)

2.5"	TJ253K-SVX	E8, E22	TJ253-SVX	1	TJ25F	1	TJ25R			7009		7219	8009		8219	9009		9219	H7016	H7018	N8016	N8018	B8516	B8518	M9516	M9518	8
4"	TJ403K-SVX	E8, E22	TJ403-SVX	1	TJ40F	1	TJ40R		Included (E10)	7009		7219	8009		8219	9009		9219	H7025	H7028	N8025	N8028	B8525	B8528	M9525	M9528	8

KIT NOTES: E8. Vehicles with 4 Cylinder Engines &/or Soft Tops will Sit a Little Higher Due to the Weight Difference. E22. 6 Speed Models May Require Additional Modification. Contact Skyjacker® for more Information.

ROCK READY® 1 SERIES - LONG ARMS WITH LOWER ROCK READY® LINKS

03-06 Wrangler TJ / Rubicon 4WD System Rock Ready® Kit (Includes NG Rebuildable Rod Ends)

4"	TJ40RR1K	E8, E10, E22, E23	TJ40RRX+TJ40XRR1	1	TJ40F	1	TJ40R		Included (E10)	Included	7112			8112		9112			H7025	H7028	N8025	N8028	B8525	B8528	M9525	M9528	10
6"	TJ60RR1K	E5, E8, E10, E16, E23	TJ68RRX+TJ60RR1	1	TJ60F	1	TJ60R		Included (E10)	Included	7112			8112		9112			H7049	H7063	N8049	N8063	B8549	B8563	M9549	M9563	12

KIT NOTES: E5. Slip Yoke Eliminator Kit # RR231 & Replacement CV Driveshaft is REQUIRED. Available Direct from Skyjacker®. E8. Vehicles with 4 Cylinder Engines &/or Soft Tops will Sit a Little Higher Due to the Weight Difference. E10. # JA750 Included for Power Steering - Order # JA850 for Manual Steering. E16. Modifications to the Factory Exhaust Cross-Over Pipe will be Necessary. E22. 6 Speed Models May Require Additional Modification. Contact Skyjacker® for more Information. E23. Order Part # JUL48SFX to make Rock Ready 2, which Includes Upper Front & Rear Links.

ROCK READY® 2 SERIES - LONG ARMS WITH UPPER & LOWER ROCK READY® LINKS

03-06 Wrangler TJ / Rubicon 4WD System Rock Ready® Kit (Includes NG Rebuildable Rod Ends)

6"	TJ60RR2K	E5, E8, E10, E16	TJ68RRX+TJ60X2	1	TJ60F	1	TJ60R		Included (E10)	Included	7112			8112		9112			H7049	H7063	N8049	N8063	B8549	B8563	M9549	M9563	12
6"	TJ676XPN	E5, E8, E10, E16	Included	1	Included	1	Included		Included (E10)	Included	7112			8112		9112					Included	Included					12

KIT NOTES: Kit # TJ676XPN - Skid Plate SP176 will Not Work with Mnual Transmission.

8"	TJ80RR2K	E5, E8, E10, E16	TJ68RRX+TJ80X2	1	TJ80F	1	TJ80R		Included	Included	7112			8112		9112			H7049	H7063	N8049	N8063	B8549	B8563	M9549	M9563	12
----	----------	------------------	----------------	---	-------	---	-------	--	----------	----------	------	--	--	------	--	------	--	--	-------	-------	-------	-------	-------	-------	-------	-------	----

KIT NOTES: E5. Slip Yoke Eliminator Kit # RR231 & Replacement CV Driveshaft is REQUIRED. Available Direct from Skyjacker®. E8. Vehicles with 4 Cylinder Engines &/or Soft Tops will Sit a Little Higher Due to the Weight Difference. E10. # JA750 Included for Power Steering - Order # JA850 for Manual Steering. E16. Modifications to the Factory Exhaust Cross-Over Pipe will be Necessary. E22. 6 Speed Models May Require Additional Modification. Contact Skyjacker® for more Information. E23. Order Part # JUL48SFX to make Rock Ready 2, which Includes Upper Front & Rear Links.

97-02 WRANGLER TJ 4WD

NOTE: ALL SHOCKS MUST BE ORDERED SEPARATELY

POLYURETHANE VALUE KIT

97-02 Wrangler TJ 4WD Kit Polyurethane Spacers

2"	TJ20		TJ20							7009	7119	7219	8009	8119	8219	9009	9119	9219	H7016	H7018	N8016	N8018	B8516	B8518	M9516	M9518	4
----	------	--	------	--	--	--	--	--	--	------	------	------	------	------	------	------	------	------	-------	-------	-------	-------	-------	-------	-------	-------	---

STANDARD SERIES - STANDARD LINKS

97-02 Wrangler TJ 4WD System Includes Front & Rear Springs

2.5"	TJ250K		TJ250	1	TJ25F	1	TJ25R			7009	7119	7219	8009	8119	8219	9009	9119	9219	H7016	H7018	N8016	N8018	B8516	B8518	M9516	M9518	6
------	--------	--	-------	---	-------	---	-------	--	--	------	------	------	------	------	------	------	------	------	-------	-------	-------	-------	-------	-------	-------	-------	---

KIT NOTES: Kit # TJ250K Includes Rear Track Bar Bracket & Rear Cam Bolts. Optional Lower Control Arms Part # TJLL24. Optional Transfer Case Lowering Kit Part # TCL101.

2.5"	TJ25BPH	E8, E12	Included		Included		Included												Included	Included							6
3"	TJ30BPH	E8, E12	Included		Included		Included			7009		7219	8009		8219	9009		9219	Included	Included							
4"	TJ401BPH	E8, E10, E12	Included		Included		Included		Included (E10)	7009	7119	7219	8009	8119	8219	9009	9119	9219	Included	Included							6

KIT NOTES: Kit # TJ401BPH Includes Front & Rear Lower Links, Rear Track Bar Bracket, Drop Pitman Arm, Transfer Case Lowering Kit, Front & Rear Extended End Links. E8. Vehicles with 4 Cylinder Engines &/or Soft Tops will Sit a Little Higher Due to the Weight Difference. E10. # JA750 Included for Power Steering - Order # JA850 for Manual Steering. E12. See Page 219 for Brake Lines.

4"	TJ401BPHX	E8, E10, E12	Included		Included		Included		Included (E10)	7009		7219	8009		8219	9009		9219	Included	Included							6
----	-----------	--------------	----------	--	----------	--	----------	--	----------------	------	--	------	------	--	------	------	--	------	----------	----------	--	--	--	--	--	--	---

KIT NOTES: Kit # TJ401BPHX Includes Front & Rear Single Flex Lower Links, Rear Track Bar Bracket, Drop Pitman Arm, Transfer Case Lowering Kit, Front & Rear Extended End Links. E8. Vehicles with 4 Cylinder Engines &/or Soft Tops will Sit a Little Higher Due to the Weight Difference. E10. # JA750 Included for Power Steering - Order # JA850 for Manual Steering. E12. See Page 219 for Brake Lines.

4"	TJ4013PH	E8, E10	Included	1	Included	1	Included			7009		7219	8009		8219	9009		9219	Included	Included							6
----	----------	---------	----------	---	----------	---	----------	--	--	------	--	------	------	--	------	------	--	------	----------	----------	--	--	--	--	--	--	---

VALUE FLEX SERIES - SHORT ARMS WITH LOWER LINKS ONLY

97-02 Wrangler TJ 4WD System Includes Front & Rear Springs (Includes NG Rebuildable Rod Ends)

2.5"	TJ251K-SVX	E8, E12	TJ251-SVX	1	TJ25F	1	TJ25R			7009	7119	7219	8009	8119	8219	9009	9119	9219	H7016	H7018	N8016	N8018	B8516	B8518	M9516	M9518	8
4"	TJ401K-SVX	E8, E10, E12	TJ401-SVX	1	TJ40F	1	TJ40R		Included (E10)	7009	7119	7219	8009	8119	8219	9009	9119	9219	H7025	H7028	N8025	N8028	B8525	B8528	M9525	M9528	8

KIT NOTES: E8. Vehicles with 4 Cylinder Engines &/or Soft Tops will Sit a Little Higher Due to the Weight Difference. E10. # JA750 Included for Power Steering - Order # JA850 for Manual Steering. E12. See Page 219 for Brake Lines.

LIFT	Quick Kit Reference	KIT NOTES	Component Box (Requires 1 of Each)	Front Springs				Rear Springs				Add-A-Leafs	Steering Correction (Order 1 Each)	Steering Stabilizers						HYDRO Shocks		NITRO Shocks		BLACK MAX		M95 Shocks		Labor Hours			
				Qty	Part #	Qty	Part #	White			Black			Silver			White		White		Black		Silver								
								OEM	Single	Dual	OEM			Single	Dual	OEM	Single	Dual	Front	Rear	Front	Rear	Front	Rear	Front	Rear	Front		Rear		
ROCK READY® 1 SERIES - LONG ARMS WITH LOWER LINKS ONLY																															
97-02 Wrangler TJ / Rubicon 4WD System Rock Ready® Kit (Includes NG Rebuildable Rod Ends)																															
4"	TJ40RR1K	E8, E10, E22, E23	TJ40RRX+TJ40XRR1	1	TJ40F	1	TJ40R					Included (E10)	Included	7112			8112			9112			H7025	H7028	N8025	N8028	B8525	B8528	M9525	M9528	10
6"	TJ60RR1K	E5, E8, E10, E16, E23	TJ68RRX+TJ60RR1	1	TJ60F	1	TJ60R					Included (E10)	Included	7112			8112			9112			H7049	H7063	N8049	N8063	B8549	B8563	M9549	M9563	12
KIT NOTES: E5. Slip Yoke Eliminator Kit # RR231 & Replacement CV Driveshaft is REQUIRED. Available Direct from Skyjacker®. E8. Vehicles with 4 Cylinder Engines &/or Soft Tops will Sit a Little Higher Due to the Weight Difference. E10. # JA750 Included for Power Steering - Order # JA850 for Manual Steering. E12. See Page 219 for Brake Lines. E16. Modifications to the Factory Exhaust Cross-Over Pipe will be Necessary. E22. 6 Speed Models May Require Additional Modification. Contact Skyjacker® for More Information. E23. Order Part # JUL48SFX to make Rock Ready 2, which Includes Upper Front & Rear Links.																															
ROCK READY® 2 SERIES - LONG ARMS WITH UPPER & LOWER LINKS																															
97-02 Wrangler TJ / Rubicon 4WD System Rock Ready® Kit (Includes NG Rebuildable Rod Ends)																															
6"	TJ60RR2K	E5, E8, E10, E16	TJ68RRX+TJ60X2	1	TJ60F	1	TJ60R					Included (E10)	Included	7112			8112			9112			H7049	H7063	N8049	N8063	B8549	B8563	M9549	M9563	12
6"	TJ676XP	E5, E8, E10, E16	Included	1	Included	1	Included					Included (E10)	Included	7112			8112			9112					Included	Included					12
8"	TJ80RR2K	E5, E8, E10, E16	TJ68RRX+TJ80X2	1	TJ80F	1	TJ80R					Included	Included	7112			8112			9112			H7049	H7063	N8049	N8063	B8549	B8563	M9549	M9563	12
KIT NOTES: E5. Slip Yoke Eliminator Kit # RR231 & Replacement CV Driveshaft is REQUIRED. Available Direct from Skyjacker®. E8. Vehicles with 4 Cylinder Engines &/or Soft Tops will Sit a Little Higher Due to the Weight Difference. E10. # JA750 Included for Power Steering - Order # JA850 for Manual Steering. E16. Modifications to the Factory Exhaust Cross-Over Pipe will be Necessary.																															
87-96 WRANGLER YJ 4WD SPORT SERIES SYSTEMS													NOTE: ALL SHOCKS MUST BE ORDERED SEPARATELY																		
87-96 Wrangler YJ 4WD System *With Power Steering																															
2.5"	YJ21BKH		YJ21BH	2	YJ20FSB	2	YJ20RSB						7009	7109	7200	8009	8109	8200	9009	9109	9200	Included	Included								4
4"	YJ41BKH	E12, E19, E20	YJ41BH	2	YJ40FSB	2	YJ40RSB					JA750*	7009	7109	7200	8009	8109	8200	9009	9109	9200	Included	Included								6
KIT NOTES: E12. See Page 219 for Brake Lines. E19. Front Sway Bar Links Included. E20. Transfer Case Lowering Kit Included. *For Manual Steering Order JA850																															
SOFRIDE® LEAF SPRING SYSTEMS																															
87-96 Wrangler YJ 4WD System *With Power Steering																															
2-2.5"	YJ20K		YJ20	2	YJ20FS	2	YJ20RS						7009	7109	7200	8009	8109	8200	9009	9109	9200	H7056	H7023	N8056	N8023	B8556	B8523	M9556	M9523	4	
3.5-4"	YJ40K	E12, E17, E18	YJ40	2	YJ40FS	2	YJ40RS					JA750*	7009	7109	7200	8009	8109	8200	9009	9109	9200	H7059	H7088	N8059	N8088	B8559	B8588	M9559	M9558	6	
KIT NOTES: E12. See Page 219 for Brake Lines. E17. Front Sway Bar Links (Disconnects) will be Needed. Part # SBE425. E18. Transfer Case Lowering Kit Required. Part # TCL25. *For Manual Steering Order JA850																															
ROCK READY® DOUBLE MILITARY WRAP																															
87-96 Wrangler YJ 4WD System *With Power Steering																															
2.5"	YJ25K	E6, E7, E12	YJ25	2	YJ25FS	2	YJ25RS						7009	7109	7200	8009	8109	8200	9009	9109	9200	H7056	H7023	N8056	N8023	B8556	B8523	M9556	M9523	4	
4"	YJ45K	E6, E12, E17, E18	YJ45	2	YJ45FS	2	YJ45RS					JA750*	7009	7109	7200	8009	8109	8200	9009	9109	9200	H7059	H7088	N8059	N8088	B8559	B8588	M9559	M9558	6	
KIT NOTES: E6. # YJ5LK - 5th Link Traction Bar is Highly Recommended - See Jeep Accessories. E7. Can be Used as Spring - Over Axle Application. E12. See Page 219 for Brake Lines. E17. Front Sway Bar Links (Disconnects) will be Needed. Part # SBE425. E18. Transfer Case Lowering Kit Required. Part # TCL25. *For Manual Steering Order JA850																															
ROCK READY® MONOLINEAR (SINGLE LEAF SPRING)																															
87-96 Wrangler YJ 4WD System *With Power Steering																															
6"	YJ60MK	E4, E5, E6	YJ60M									JA750*	7009	7109	7200	8009	8109	8200	9009	9109	9200	H7061	H7088	N8061	N8088	B8561	B8588	M9561	M9558	10	
KIT NOTES: E4. This Component Box Includes the 4 Monolinear Leaves. E5. Slip Yoke Eliminator Kit # RR231 & Replacement CV Driveshaft is REQUIRED. Available Direct from Skyjacker®. E6. # YJ5LK - 5th Link Traction Bar is Highly Recommended - See Jeep Accessories. *For Manual Steering Order JA850																															
76-86 CJ5, CJ7, CJ8 4WD SPORT SERIES SYSTEMS													NOTE: ALL SHOCKS MUST BE ORDERED SEPARATELY																		
76-86 CJ5, CJ7, CJ8 WD System With Power Steering																															
2.5"	J21BKH	E2, E12	J21BH	2	J20FSB	2	J20RSB						7001	7100	7200	8009	8100	8200	9009	9100	9200	Included	Included								
4"	J41BKH	E2, E12	J41BH	2	J40FSB	2	J40RSB					JA250	7001	7100	7200	8009	8100	8200	9009	9100	9200	Included	Included								
KIT NOTES: E2. Scrambler Models May Require an Additional Rear "Fitted" Leaf (Ordered Separately - See Page 218). E12. See Page 219 for Brake Lines.																															
76-86 CJ5, CJ7, CJ8 WD System With Manual Steering																															
2.5"	J21BKH	E2, E12	J21BH	2	J20FSB	2	J20RSB						7001	7100	7200	8009	8100	8200	9009	9100	9200	Included	Included								
4"	J41BKH	E2, E12	J41BH	2	J40FSB	2	J40RSB					JA150	7001	7100	7200	8009	8100	8200	9009	9100	9200	Included	Included								
KIT NOTES: E2. Scrambler Models May Require an Additional Rear "Fitted" Leaf (Ordered Separately - See Page 218). E12. See Page 219 for Brake Lines.																															
SOFRIDE® LEAF SPRING SYSTEMS																															
76-86 CJ5, CJ7, CJ8 4WD System With Power Steering																															
2-2.5"	J20K	E2, E12	J24	2	J20FS	2	J20RS						7001	7100	7200	8009	8100	8200	9009	9100	9200	H7012	H7023	N8012	N8023	B8512	B8523	M9512	M9523	4	
3.5-4"	J40K	E2, E12	J24	2	J40FS	2	J40RS					JA250	7001	7100	7200	8009	8100	8200	9009	9100	9200	H7023	H7058	N8023	N8058	B8523	B8558	M9523	M9558	4	
KIT NOTES: E2. Scrambler Models May Require an Additional Rear "Fitted" Leaf (Ordered Separately - See Page 218). E12. See Page 219 for Brake Lines.																															

LIFT	Quick Kit Reference	KIT NOTES	Component Box (Requires 1 of Each)	Front Springs		Rear Springs		Add-A- Leafs	Steering Correction (Order 1 Each)	Steering Stabilizers						HYDRO Shocks		NITRO Shocks		BLACK MAX		M95 Shocks		Labor Hours			
				Qty	Part #	Qty	Part #			White		Black		Silver		White		Black		Silver							
										OEM	Single	Dual	OEM	Single	Dual	OEM	Single	Dual	Front	Rear	Front	Rear	Front		Rear	Front	Rear
76-86 CJ5, CJ7, CJ8 4WD System																											
With Manual Steering																											
2-2.5"	J20K	E2, E12	J24	2	J20FS	2	J20RS			7001	7100	7200	8009	8100	8200	9009	9100	9200	H7012	H7023	N8012	N8023	B8512	B8523	M9512	M9523	4
3.5-4"	J40K	E2, E12	J24	2	J40FS	2	J40RS		JA150	7001	7100	7200	8009	8100	8200	9009	9100	9200	H7023	H7058	N8023	N8058	B8523	B8558	M9523	M9558	4
KIT NOTES: E2. Scrambler Models May Require an Additional Rear "Fitted" Leaf (Ordered Separately - See Page 218). E12. See Page 219 for Brake Lines.																											
72-75 CJ5, CJ7 4WD																											
NOTE: ALL SHOCKS MUST BE ORDERED SEPARATELY																											
72-75 CJ5, CJ6 4WD System																											
With Power Steering																											
2-2.5"	J32K	E12	J34	2	J32FS	2	J32RS		JA552		7100	7200		8100	8200		9100	9200	H7023	H7023	N8023	N8023	B8512	B8523	M9523	M9523	4
3.5-4"	J34K	E12	J34	2	J34FS	2	J34RS		JA550		7100	7200		8100	8200		9100	9200	H7058	H7058	N8058	N8058	B8523	B8558	M9558	M9558	4
KIT NOTES: E12. See Page 219 for Brake Lines.																											
72-75 CJ5, CJ6 4WD System																											
With Manual Steering																											
2-2.5"	J32K	E12	J34	2	J32FS	2	J32RS		JA652		7100	7200		8100	8200		9100	9200	H7023	H7023	N8023	N8023	B8512	B8523	M9523	M9523	4
3.5-4"	J34K	E12	J34	2	J34FS	2	J34RS		JA650		7100	7200		8100	8200		9100	9200	H7058	H7058	N8058	N8058	B8523	B8558	M9558	M9558	4
KIT NOTES: E12. See Page 219 for Brake Lines.																											
55-71 CJ5, CJ6 4WD																											
NOTE: ALL SHOCKS MUST BE ORDERED SEPARATELY																											
55-71 CJ5, CJ6 4WD System																											
Includes Front & Rear Springs																											
2-2.5"	J32K	E12	J34	2	J32FS	2	J32RS				7100	7200		8100	8200		9100	9200	H7023	H7023	N8023	N8023	B8512	B8523	M9523	M9523	4
3.5-4"	J34K	E12	J34	2	J34FS	2	J34RS				7100	7200		8100	8200		9100	9200	H7058	H7058	N8058	N8058	B8523	B8558	M9558	M9558	4
KIT NOTES: E12. See Page 219 for Brake Lines.																											
74-91 CHEROKEE / WAGONEER 4WD - FULL-SIZE																											
NOTE: ALL SHOCKS MUST BE ORDERED SEPARATELY																											
84-91 Cherokee / Wagoneer 4WD Kit																											
With Rear Blocks																											
3.5-4"	JP45K	E9, E12	JP45	2	JP40FS				JA350	7009			8009			9009			H7088	H7088	N8088	N8088	B8588	B8588	M9558	M9558	4
KIT NOTES: E9. Power Steering Models Only. E12. See Page 219 for Brake Lines.																											
84-91 Cherokee / Wagoneer 4WD System																											
Includes Front & Rear Full Height Replacement Springs																											
3.5-4"	JP45KS	E9, E12	JP45S	2	JP40FS	2	JP40RS		JA350	7009			8009			9009			H7088	H7088	N8088	N8088	B8588	B8588	M9558	M9558	4
KIT NOTES: E9. Power Steering Models Only. E12. See Page 219 for Brake Lines.																											
74-83 Cherokee / Wagoneer 4WD Kit																											
With Rear Blocks																											
3.5-4"	JP40K	E9, E12	JP40	2	JP40FS				JA350	7005			8005			9005			H7088	H7088	N8088	N8088	B8588	B8588	M9558	M9558	4
KIT NOTES: E9. Power Steering Models Only. E12. See Page 219 for Brake Lines.																											
76-83 Cherokee / Wagoneer 4WD System																											
Includes Front & Rear Full Height Replacement Springs																											
3.5-4"	JP40KS	E9, E12	JP40S	2	JP40FS	2	JP40RS		JA350	7005			8005			9005			H7088	H7088	N8088	N8088	B8588	B8588	M9558	M9558	4
KIT NOTES: E9. Power Steering Models Only. E12. See Page 219 for Brake Lines.																											
74-88 J10, J20 PICKUP 4WD - FULL-SIZE																											
NOTE: ALL SHOCKS MUST BE ORDERED SEPARATELY																											
74-88 J10, J20 Pickup 4WD Kit																											
With Rear Blocks																											
3.5-4"	JP40K	E9, E12	JP40	2	JP40FS				JA350	7005			8005			9005			H7088	H7088	N8088	N8088	B8588	B8588	M9558	M9558	4
KIT NOTES: E9. Power Steering Models Only. E12. See Page 219 for Brake Lines.																											
74-88 J10, J20 Pickup 4WD System																											
Includes Front & Rear Full Height Replacement Springs																											
3.5-4"	JP40KS	E1, E9, E12	JP40S	2	JP40FS	2	JP40RS		JA350	7005			8005			9005			H7088	H7088	N8088	N8088	B8588	B8588	M9558	M9558	4
KIT NOTES: E1. 74-75 Models MUST have 131" Wheel Base & 7,200 lb. GVWR or More for Rear Springs to Fit. E9. Power Steering Models Only. E12. See Page 219 for Brake Lines.																											
84-01 CHEROKEE XJ 4WD, 2WD																											
POLYURETHANE VALUE KIT																											
84-01 Cherokee XJ 4WD, 2WD Kit																											
Polyurethane Spacers																											
2"	XJ20		XJ20							7009			8009			9009			H7016	H7018	N8016	N8018	B8516	B8518	M9516	M9518	4
KIT NOTES: Includes Rear Lift Shackles.																											
SPORT SERIES																											
84-01 Cherokee XJ 4WD, 2WD Kit																											
With Rear Add-A-Leafs																											
3"	JC31BKH	E12	JC301BH		Included		Included			7009			8009			9009			Included	Included							
KIT NOTES: E12. See Page 219 for Brake Lines.																											
84-01 Cherokee XJ 4WD, 2WD System																											
With Replacement Rear Springs (Dana 35 Rear Axle)																											
3"	JC315BKSH	E12	JC315BSH		Included	2	JC25RSB			7009			8009			9009			Included	Included							
6"	JC605BKSH	E5, E11	JC60RRX + JC605BSH	1	JC60F	2	JC55RSB			7009			8009			9009			Included	Included							
KIT NOTES: E5. Slip Yoke Eliminator Kit # RR231 & Replacement CV Driveshaft is REQUIRED. Available Direct from Skyjacker®. E11. Transfer Case Lowering Kit Required - Part # TCL32. E12. See Page 219 for Brake Lines.																											

LIFT	Quick Kit Reference	KIT NOTES	Component Box (Requires 1 of Each)	Front Springs		Rear Springs		Add-A-Leafs	Steering Correction (Order 1 Each)	Steering Stabilizers						HYDRO Shocks		NITRO Shocks		BLACK MAX		M95 Shocks		Labor Hours							
				Qty	Part #	Qty	Part #			White		Black		Silver		White		Black		Silver											
										OEM	Single	Dual	OEM	Single	Dual	OEM	Single	Dual	Front	Rear	Front	Rear	Front		Rear	Front	Rear				
84-01 Cherokee XJ 4WD, 2WD System																															
With Replacement Rear Springs (Chrysler 8.25" Rear Axle)																															
3"	JC318BKSH	E12	JC318BSH		Included	2	JC25RSB			7009			8009			9009			Included	Included											
6"	JC608BKSH	E5, E11	JC60RRX + JC608BSH	1	JC60F	2	JC55RSB			7009			8009			9009			Included	Included											
KIT NOTES: E5. Slip Yoke Eliminator Kit # RR231 & Replacement CV Driveshaft is REQUIRED. Available Direct from Skyjacker®. E11. Transfer Case Lowering Kit Required - Part # TCL32. E12. See Page 219 for Brake Lines.																															
STANDARD SERIES																															
84-01 Cherokee XJ 4WD, 2WD Kit																															
With Rear Add-A-Leafs																															
3"	JC301K	E12	JC30	1	JC30F			R3136		7009			8009			9009			H7016	H7018	N8016	N8018	B8516	B8518	M9516	M9518	6				
4.5"	JC451K	E12	JC45	1	JC45F			R3136		7009			8009			9009			H7025	H7028	N8025	N8028	B8525	B8528	M9525	M9528	6				
KIT NOTES: E12. See Page 219 for Brake Lines.																															
84-01 Cherokee XJ 4WD, 2WD System																															
With Replacement Rear Springs																															
3"	JC301KS	E12	JC30S	1	JC30F	2	JC25RS			7009			8009			9009			H7016	H7018	N8016	N8018	B8516	B8518	M9516	M9518	6				
KIT NOTES: E12. See Page 219 for Brake Lines.																															
VALUE FLEX SERIES																															
84-01 Cherokee XJ 4WD, 2WD Kit																															
With Rear Add-A-Leafs																															
3"	JC301K-SVX	E12	JC30-SVX	1	JC30F			R3136		7009			8009			9009			H7016	H7018	N8016	N8018	B8516	B8518	M9516	M9518	6				
4.5"	JC451K-SVX	E11, E12	JC45-SVX	1	JC45F			R3136		7009			8009			9009			H7025	H7028	N8025	N8028	B8525	B8528	M9525	M9528	6				
KIT NOTES: E11. Transfer Case Lowering Kit Required - Part # TCL32. E12. See Page 219 for Brake Lines.																															
84-01 Cherokee XJ 4WD, 2WD System																															
With Replacement Rear Springs																															
3"	JC301KS-SVX		JC30S-SVX	1	JC30F	2	JC25RS			7009			8009			9009			H7016	H7018	N8016	N8018	B8516	B8518	M9516	M9518	6				
ROCK READY® 2 SERIES																															
84-01 Cherokee XJ 4WD, 2WD System																															
With Replacement Rear Springs (Dana 35 Rear Axle)																															
4.5"	JC455RR2KS		JC48RRX+JC405XS2	1	JC45F	2	JC25RS		Included	Included									H7025	H7028	N8025	N8028	B8525	B8528	M9525	M9528	10				
6"	JC605RR2KS	E5, E11	JC48RRX+JC605XS2	1	JC60F	2	JC55RS		Included	Included									H7049	H7063	N8049	N8063	B8549	B8563	M9549	M9563	10				
KIT NOTES: E5. Slip Yoke Eliminator Kit # RR231 (See Jeep Accessories) & Replacement CV Driveshaft is REQUIRED. E11. Transfer Case Lowering Kit Required - Part # TCL32.																															
84-01 Cherokee XJ 4WD, 2WD System																															
With Replacement Rear Springs (Chrysler 8.25" Rear Axle)																															
4.5"	JC458RR2KS		JC48RRX+JC408XS2	1	JC45F	2	JC25RS		Included	Included									H7025	H7028	N8025	N8028	B8525	B8528	M9525	M9528	10				
6"	JC608RR2KS	E5, E11	JC48RRX+JC608XS2	1	JC60F	2	JC55RS		Included	Included									H7049	H7063	N8049	N8063	B8549	B8563	M9549	M9563	10				
84-01 Cherokee XJ 4WD, 2WD System																															
With Replacement Rear Springs (Dana 35 Rear Axle)																															
8"	JC805RR2KS	E5, E11	JC48RRX+JC805XS2	1	JC80F	2	JC75RS		Included	Included									H7049	H7063	N8049	N8063	B8549	B8563	M9549	M9563	10				
84-01 Cherokee XJ 4WD, 2WD System																															
With Replacement Rear Springs (Chrysler 8.25" Rear Axle)																															
8"	JC808RR2KS	E5, E11	JC48RRX+JC808XS2	1	JC80F	2	JC75RS		Included	Included									H7049	H7063	N8049	N8063	B8549	B8563	M9549	M9563	10				
KIT NOTES: E5. Slip Yoke Eliminator Kit # RR231 (See Jeep Accessories) & Replacement CV Driveshaft is REQUIRED. E11. Transfer Case Lowering Kit Required - Part # TCL32.																															
86-92 COMANCHE PICKUP MJ 4WD, 2WD										NOTE: ALL SHOCKS MUST BE ORDERED SEPARATELY																					
POLYURETHANE VALUE KIT																															
86-92 Comanche Pickup MJ 4WD, 2WD Kit																															
Polyurethane Spacers																															
2"	XJ20		XJ20							7009			8009			9009			H7016	H7023	N8016	N8023	B8516	B8523	M9516	M9523	4				
KIT NOTES: Includes Rear Lift Shackles.																															
STANDARD SERIES																															
86-92 Comanche Pickup MJ 4WD, 2WD Kit																															
With Rear Add-A-Leafs																															
3"	JC351K	E12	JC30	1	JC30F			R3136		7009			8009			9009			H7016	H7023	N8016	N8023	B8516	B8523	M9516	M9523	6				
KIT NOTES: E12. See Page 219 for Brake Lines.																															
VALUE FLEX SERIES																															
86-92 Comanche Pickup MJ 4WD, 2WD Kit																															
With Rear Add-A-Leafs (Includes NG Rebuildable Rod Ends)																															
3"	JC351K-SVX	E12	JC30-SVX	1	JC30F			R3136		7009			8009			9009			H7016	H7023	N8016	N8023	B8516	B8523	M9516	M9523	6				
KIT NOTES: E12. See Page 219 for Brake Lines.																															
06-10 COMMANDER XK 4WD, 2WD										NOTE: ALL SHOCKS MUST BE ORDERED SEPARATELY																					
POLYURETHANE VALUE KITS																															
06-10 Commander XK 4WD, 2WD Kit																															
Polyurethane Spacers																															
2"	XK20		XK20																---	---	H7088	---	---	N8088	---	---	B8588	---	---	M9558	6

LIFT	Quick Kit Reference	KIT NOTES	Component Box (Requires 1 of Each)	Front Springs		Rear Springs		Add-A- Leafs	Steering Correction (Order 1 Each)	Steering Stabilizers						HYDRO Shocks		NITRO Shocks		BLACK MAX		M95 Shocks		Labor Hours								
				Qty	Part #	Qty	Part #			White		Black		Silver		White		Black		Silver												
										OEM	Single	Dual	OEM	Single	Dual	OEM	Single	Dual	Front	Rear	Front	Rear	Front		Rear	Front	Rear					
08-12 LIBERTY KK 4WD, 2WD										NOTE: ALL SHOCKS MUST BE ORDERED SEPARATELY																						
08-12 Liberty KK 4WD, 2WD Kit			Polyurethane Spacers																													
2"	KKN25		KKN25																													
08-12 Liberty KK 4WD, 2WD Kit			With Rear Coil Springs																													
2.5-3"	LIB258K		LIB250			1	LIB208R																									
02-07 LIBERTY KJ 4WD, 2WD										NOTE: ALL SHOCKS MUST BE ORDERED SEPARATELY																						
VALUE KITS																																
02-07 Liberty KJ 4WD, 2WD Kit			Polyurethane Spacers																													
2.5"	KJ25		KJ25																													
KIT NOTES: Installs Inside Strut Assembly.																																
PLATINUM SCOIL-OVER® SERIES																																
02-07 Liberty KJ 4WD, 2WD System			With Rear Coil Springs																													
2.5"	LIB250K	E21	LIB250			1	LIB25R																									
KIT NOTES: E21. Skyjacker® Limiting Straps Recommended. Diesel Engines will Sit Lower in Front.																																
05-10 GRAND CHEROKEE WK 4WD, 2WD										NOTE: ALL SHOCKS MUST BE ORDERED SEPARATELY																						
POLYURETHANE VALUE KIT																																
05-10 Grand Cherokee WK 4WD, 2WD Kit			Polyurethane Spacers																													
2"	WK20		WK20																													
99-04 GRAND CHEROKEE WJ 4WD, 2WD										NOTE: ALL SHOCKS MUST BE ORDERED SEPARATELY																						
POLYURETHANE VALUE KIT																																
99-04 Grand Cherokee WJ 4WD, 2WD Kit			Polyurethane Spacers																													
2"	WJ20		WJ20																					H7016	H7044	N8016	N8044	B8516	B8544	M9516	M9544	4
93-98 GRAND CHEROKEE ZJ 4WD, 2WD										NOTE: ALL SHOCKS MUST BE ORDERED SEPARATELY																						
POLYURETHANE VALUE KIT																																
93-98 Grand Cherokee ZJ 4WD, 2WD Kit			Polyurethane Spacers																													
2"	ZJ20		ZJ20							7009		8009		9009										H7016	H7023	N8016	N8023	B8516	B8523	M9516	M9523	4
STANDARD SERIES																																
93-98 Grand Cherokee ZJ 4WD, 2WD System			With Rear Coil Springs																													
3"	GC301K		GC30	1	JC30F	1	GC20R			7009		8009		9009										H7016	H7023	N8016	N8023	B8516	B8523	M9516	M9523	4